

Seattle
Convention
Center



Arch



Summit





*The Northwest's premier convention, meeting and event facility,
now has more space for your event to
experience the extraordinary.*



Your Event | Our Expertise

Our diverse and attentive team, along with our expert in-house service partners, have been making great things happen for over 30 years. Clients appreciate the flexibility provided by our tastefully appointed, versatile space and how many services and special touches are included.

Your vision and goals are as important to us as they are to you, and together we can create a memorable experience.

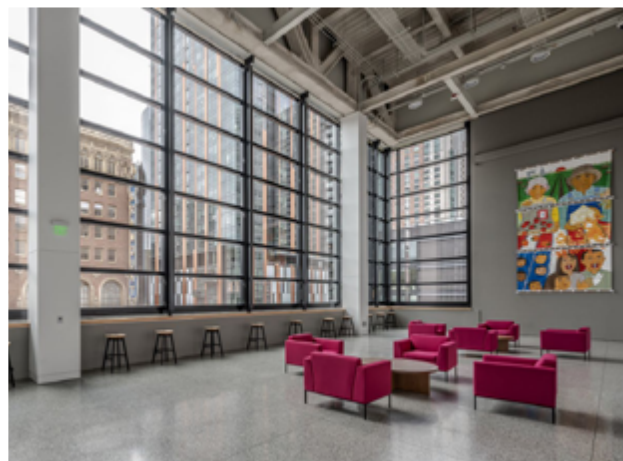

More Than Conventions

- Culinary Institute of America-trained chefs
- Variety of meeting spaces designed to accommodate all event types and sizes
- Warm, engaging staff and welcoming conversation areas
- Tailored menu planning to fit your unique needs
- Regional dishes made with locally sourced food products



Where Safe Meets Easy

- Consolidated contract and billing covering all services
- Many services, equipment and amenities included at no additional charge
- Focus on safety, sustainability and inclusivity
- GBAC STAR™ Facility Accreditation



Arch

A Seattle Original

- 434,080 sq. ft. of event space
- Three adjoining ballrooms up to 29,580 sq. ft combined; one ballroom at 15,048 sq. ft.
- Flexible meeting space with up to 70 individual rooms, including two junior ballrooms and four fixed-set conference rooms
- Registration lobbies adjacent to all function space
- Stunning Atrium and Skybridge lobbies lead into the exhibit space
- 205,700 sq. ft. of heavy-load exhibit space with direct drive-in access
- 19 covered bays at two loading docks
- Two 20,000-lb. freight elevators and two service elevators
- LEED Silver Certification

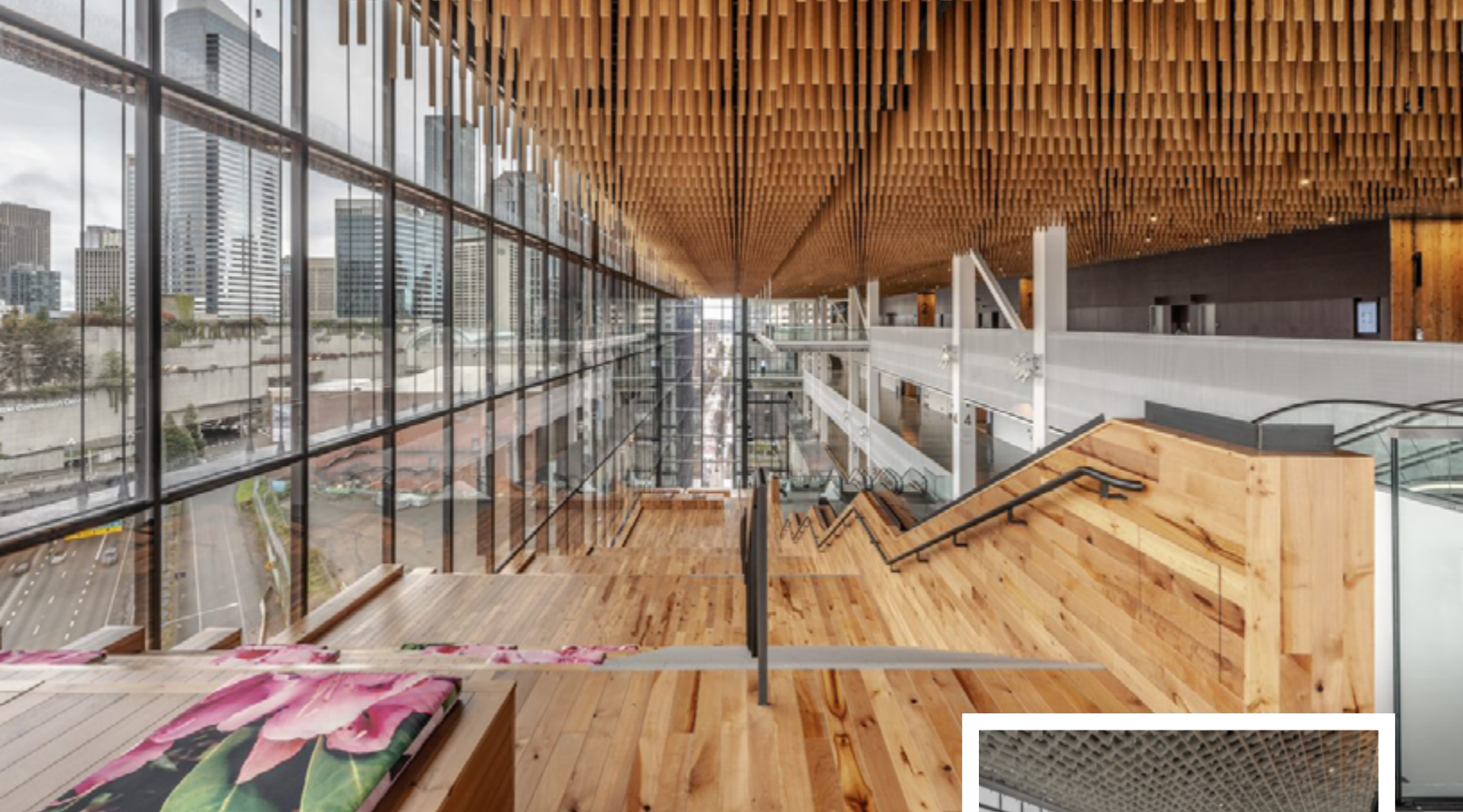

Summit

- 570,290 sq. ft. of event space
- 58,000 sq. ft. column-free and divisible ballroom with a soaring 55-ft. custom ceiling made from locally sourced recycled wood
- 62 meeting rooms totaling 99,620 sq. ft. with numerous combination possibilities
- 137,220 sq. ft. of lobby space – all naturally lit – with stunning views of mountains and water
- 99,250 sq. ft. carpeted and acoustically treated Flex Hall with 250 lbs. psf floor load
- 149,200 sq. ft. of heavy-load exhibit space with direct drive-in access
- 18 covered bays at one loading dock
- Three freight elevators and four service elevators
- LEED Platinum Certification (projected)

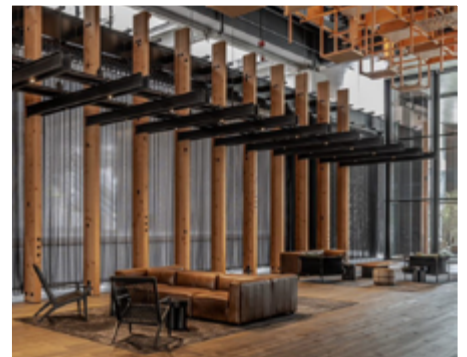

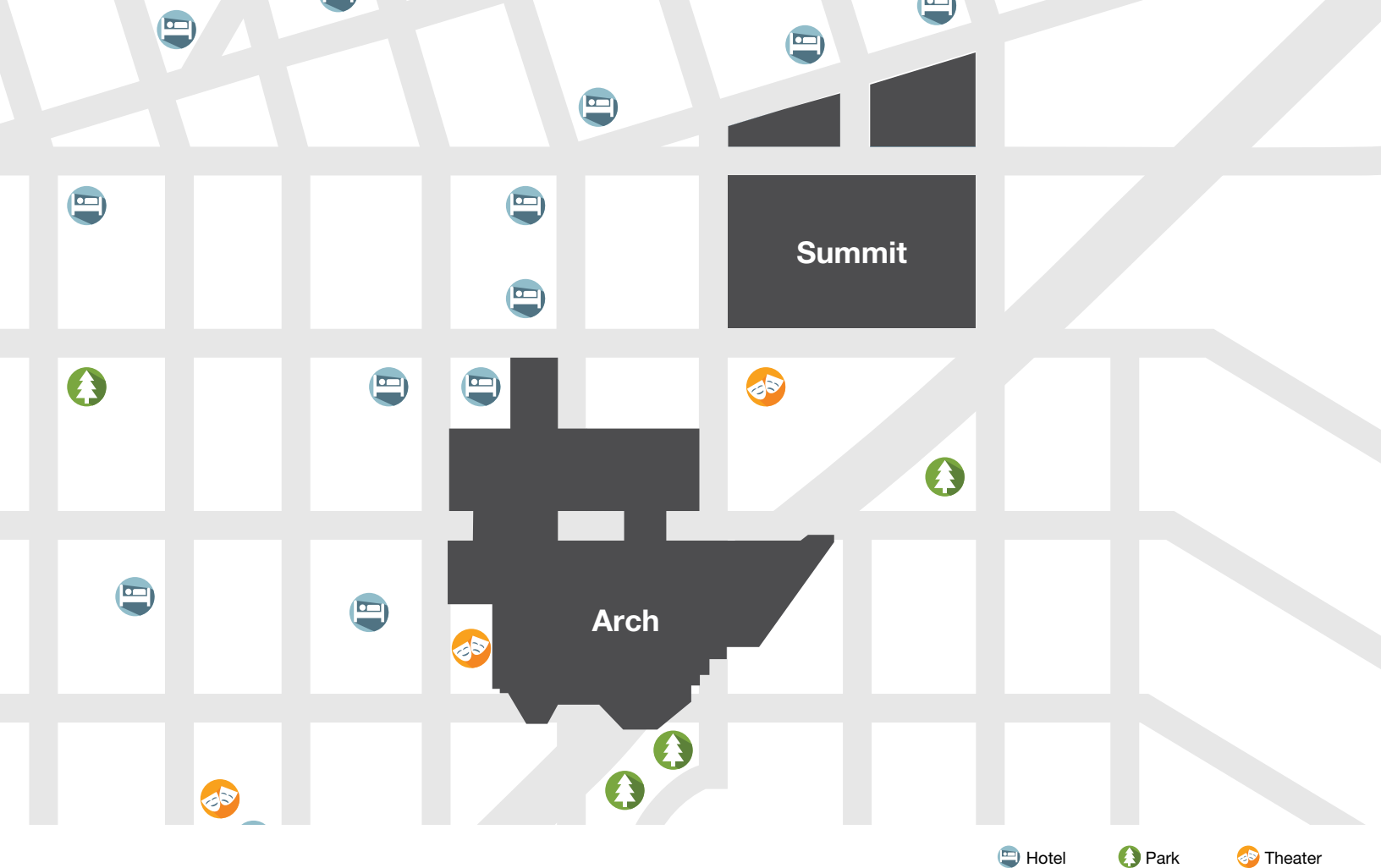

Sales Office: 705 Pike Street, Seattle WA 98101-2310 | 206-694-5060 | sales@seattleconventioncenter.com

www.seattleconventioncenter.com | @SEAConvCenter