

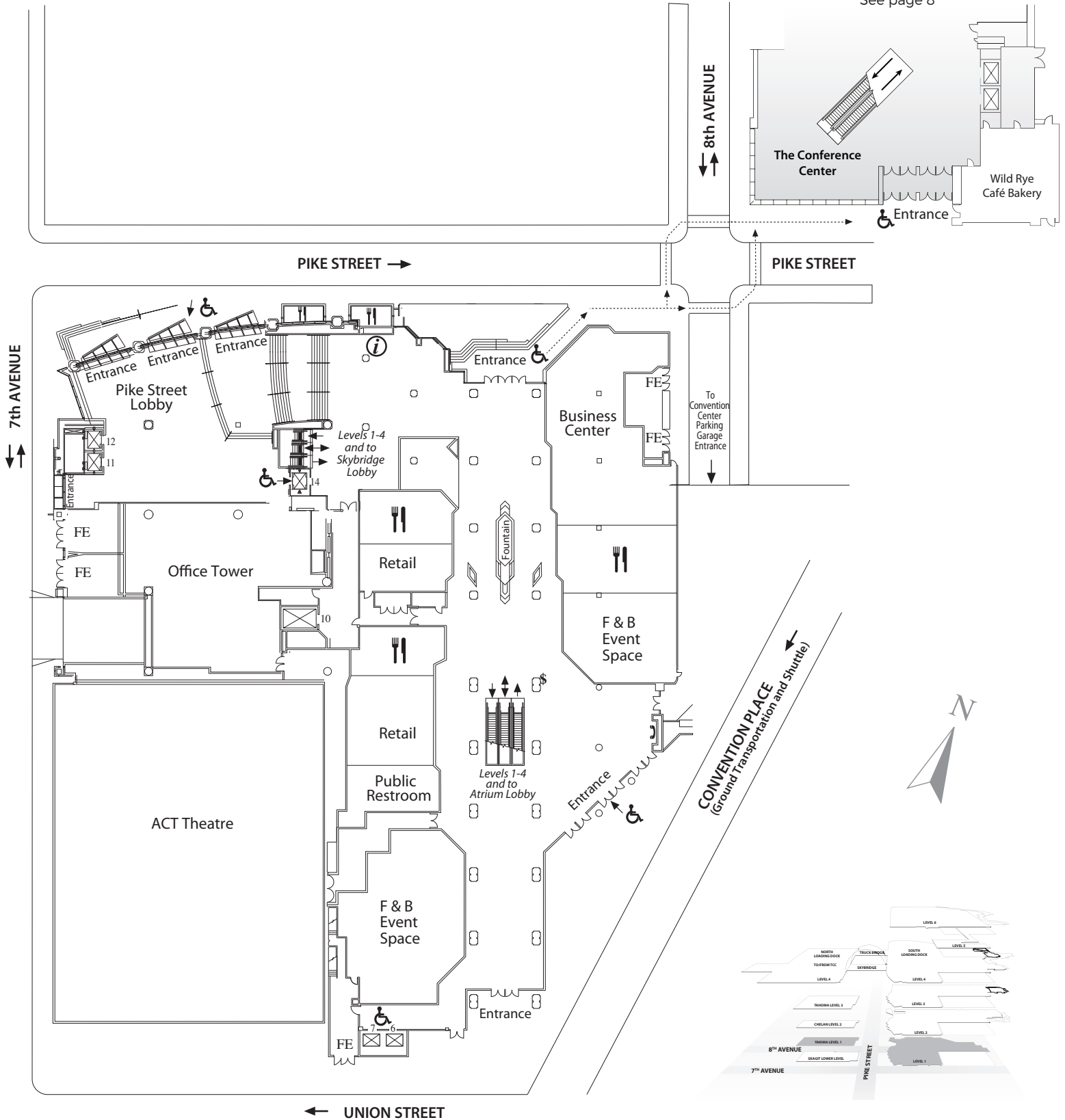

The Conference Center

See page 8



LEVEL 1 - ENTRANCES, SHOPS, & SERVICES

LEVEL 2 - MEETING ROOMS

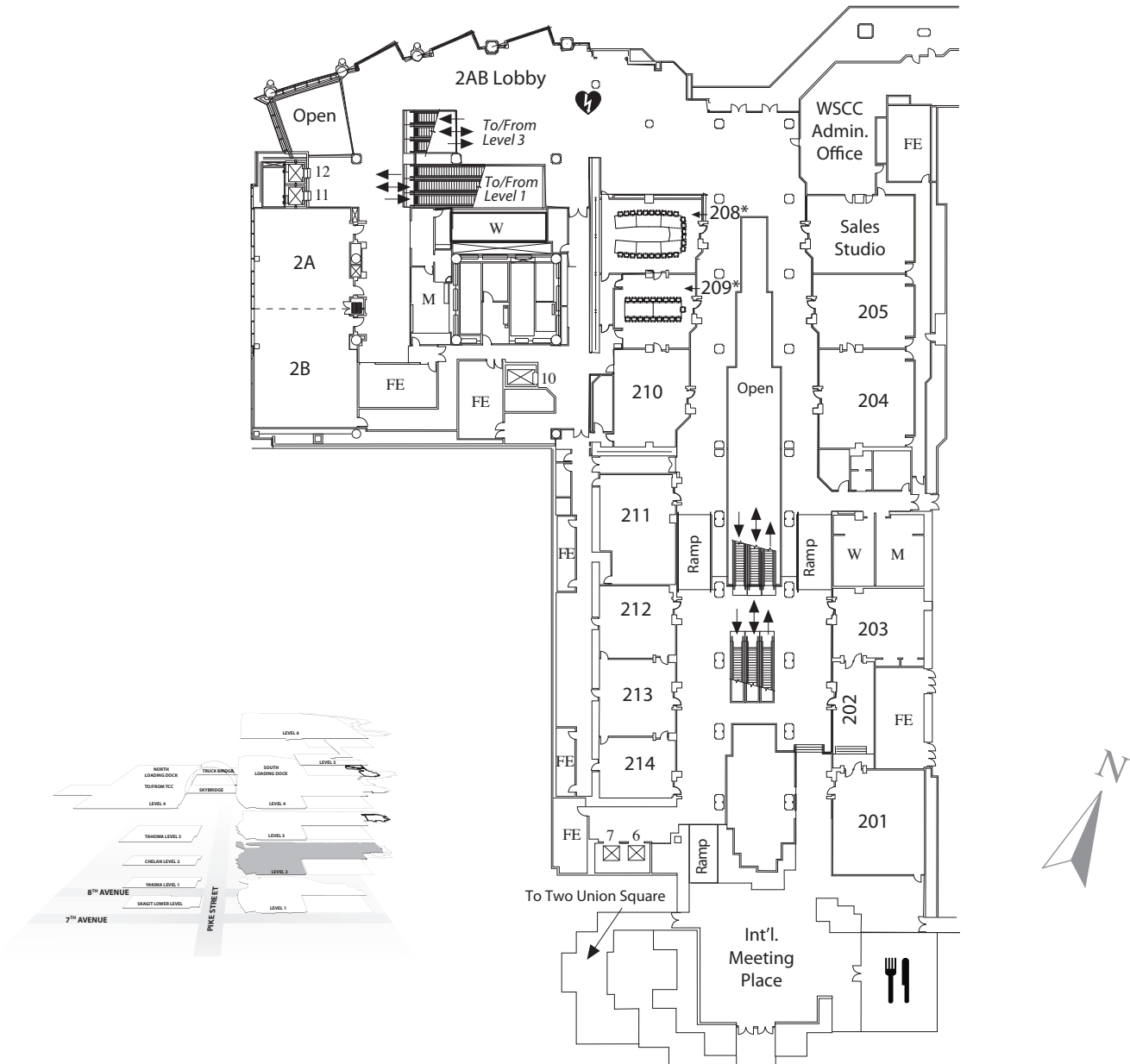

| LEVEL 2 ROOMS | Square Feet | Dimensions | Height | Theater | Classroom | | Banquet B-10 | Conference | Recommended Front |
|---------------|-------------|------------|--------|---------|-----------|-----|--------------|------------|-------------------|
| | | | | | 3pp | 4pp | | | |
| Room 201 | 1,435 | 35 x 41 | 8'6" | 147 | 63 | 84 | 90 | 48 | South |
| Room 202 | 602 | 43 x 14 | 9 | 35 | 15 | 20 | 20 | 28 | South |
| Room 203 | 1,044 | 36 x 29 | 9 | 81 | 30 | 45 | 50 | 36 | East |
| Room 204 | 1,443 | 39 x 37 | 9 | 119 | 45 | 65 | 80 | 44 | East |
| Room 205 | 1,073 | 37 x 29 | 8'11" | 96 | 34 | 51 | 60 | 38 | East |
| Room 208* | 1,160 | 40 x 29 | 9 | - | - | - | - | 26 | West |
| Room 209* | 928 | 32 x 29 | 8'10" | - | - | - | - | 20 | West |
| Room 210 | 1,170 | 39 x 30 | 9 | 70 | 35 | 50 | 42 | 24 | South |
| Room 211 | 1,247 | 43 x 30 | 9 | 119 | 42 | 63 | 70 | 38 | South |
| Room 212 | 812 | 29 x 28 | 9 | 65 | 24 | 36 | 40 | 32 | South |
| Room 213 | 840 | 30 x 28 | 9 | 70 | 27 | 39 | 40 | 32 | North |
| Room 214 | 780 | 30 x 26 | 9 | 56 | 24 | 32 | 40 | 26 | North |
| Room 2A | 1,521 | 39 x 39 | 13 | 135 | 58 | 82 | 90 | 48 | South |
| Room 2B | 1,786 | 47 x 38 | 13 | 175 | 69 | 97 | 110 | 56 | South |
| Rooms 2AB | 3,393 | 87 x 39 | 13 | 325 | 142 | 201 | 210 | 96 | South |

* Permanent Set

LEVEL 3 - MEETING ROOMS

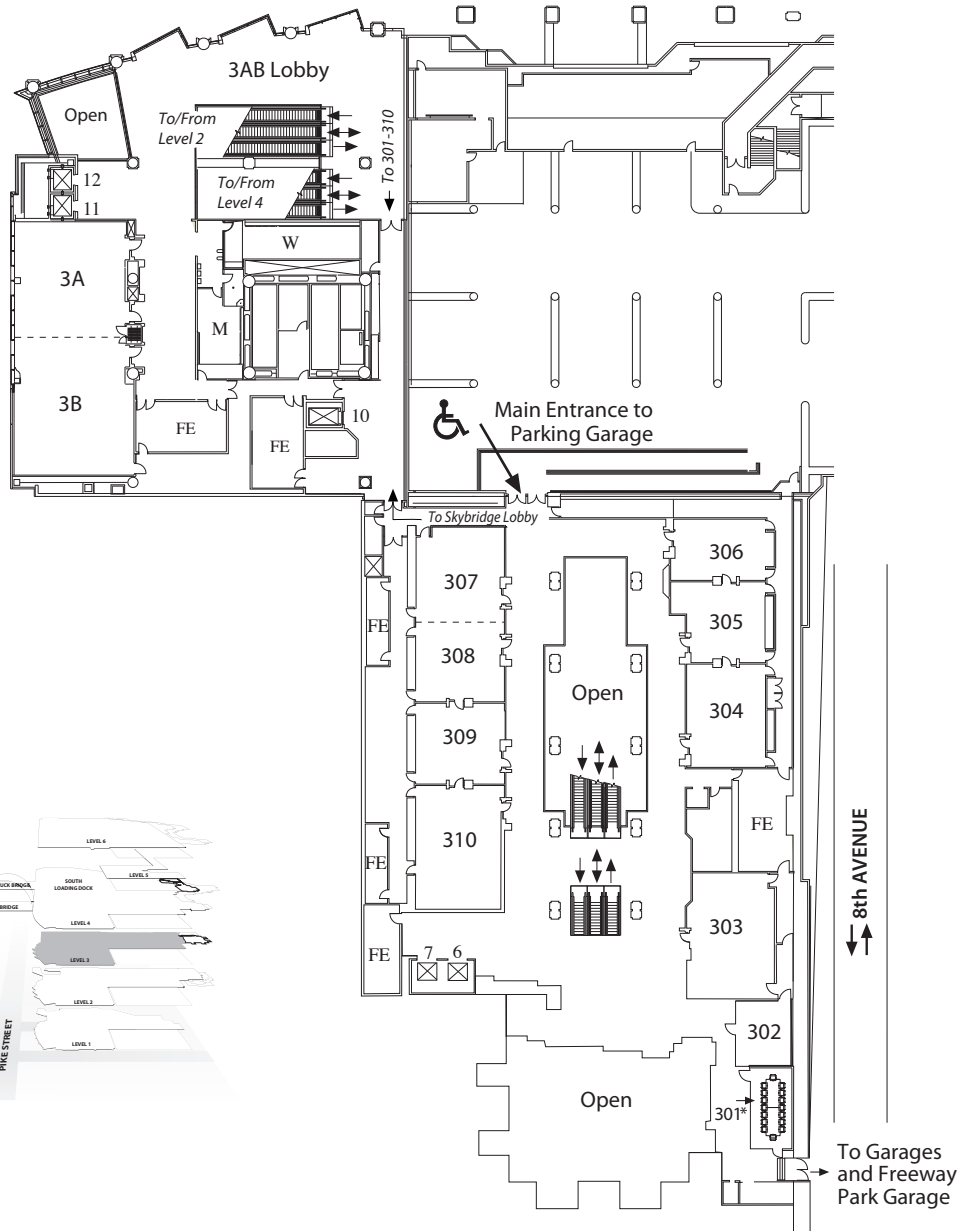

| LEVEL 3 ROOMS | Square Feet | Dimensions | Height | Theater | Classroom | | Banquet B-10 | Conference | Recommended Front |
|---------------|-------------|------------|--------|---------|-----------|-----|--------------|------------|-------------------|
| | | | | | 3pp | 4pp | | | |
| Room 301* | 450 | 30 x 15 | 8'5" | - | - | - | - | 16 | - |
| Room 302 | 460 | 23 x 20 | 8'5" | 30 | 8 | 12 | 20 | 18 | South |
| Room 303 | 1,305 | 45 x 29 | 9 | 117 | 54 | 74 | 70 | 46 | South |
| Room 304 | 918 | 34 x 27 | 9 | 79 | 30 | 40 | 60 | 32 | North |
| Room 305 | 840 | 30 x 28 | 9'6" | 55 | 24 | 32 | 40 | 24 | East |
| Room 306 | 714 | 34 x 21 | 9'6" | 53 | 20 | 30 | 30 | 30 | East |
| Room 307 | 841 | 29 x 29 | 10 | 67 | 29 | 40 | 40 | 30 | North |
| Room 308 | 812 | 28 x 29 | 10 | 61 | 24 | 32 | 40 | 30 | West |
| Rooms 307-308 | 1,653 | 57 x 29 | 10 | 156 | 63 | 90 | 80 | 56 | North |
| Room 309 | 840 | 28 x 29 | 10 | 56 | 25 | 36 | 40 | 28 | West |
| Room 310 | 1,200 | 40 x 30 | 10 | 96 | 42 | 60 | 60 | 40 | South |
| Room 3A | 1,521 | 40 x 39 | 12 | 135 | 58 | 82 | 90 | 48 | South |
| Room 3B | 1,786 | 47 x 38 | 12 | 175 | 69 | 97 | 110 | 56 | South |
| Rooms 3AB | 3,393 | 87 x 39 | 12 | 325 | 142 | 201 | 210 | 96 | South |

* Permanent Set

LEVEL 4 - EXHIBITION HALLS

| LEVEL 4 - Support Spaces | | | |
|--------------------------|------------|--------|---------|
| Room | Dimensions | Height | Sq. Ft. |
| 416 | - | 8 | 104 |
| 438 | 12 x 8 | 8 | 88 |
| 439 | 13 x 8 | 8 | 104 |
| 454 | 11 x 25 | 8 | 360 |
| Waterfall Suite | 20 x 25 | 12 | 546 |

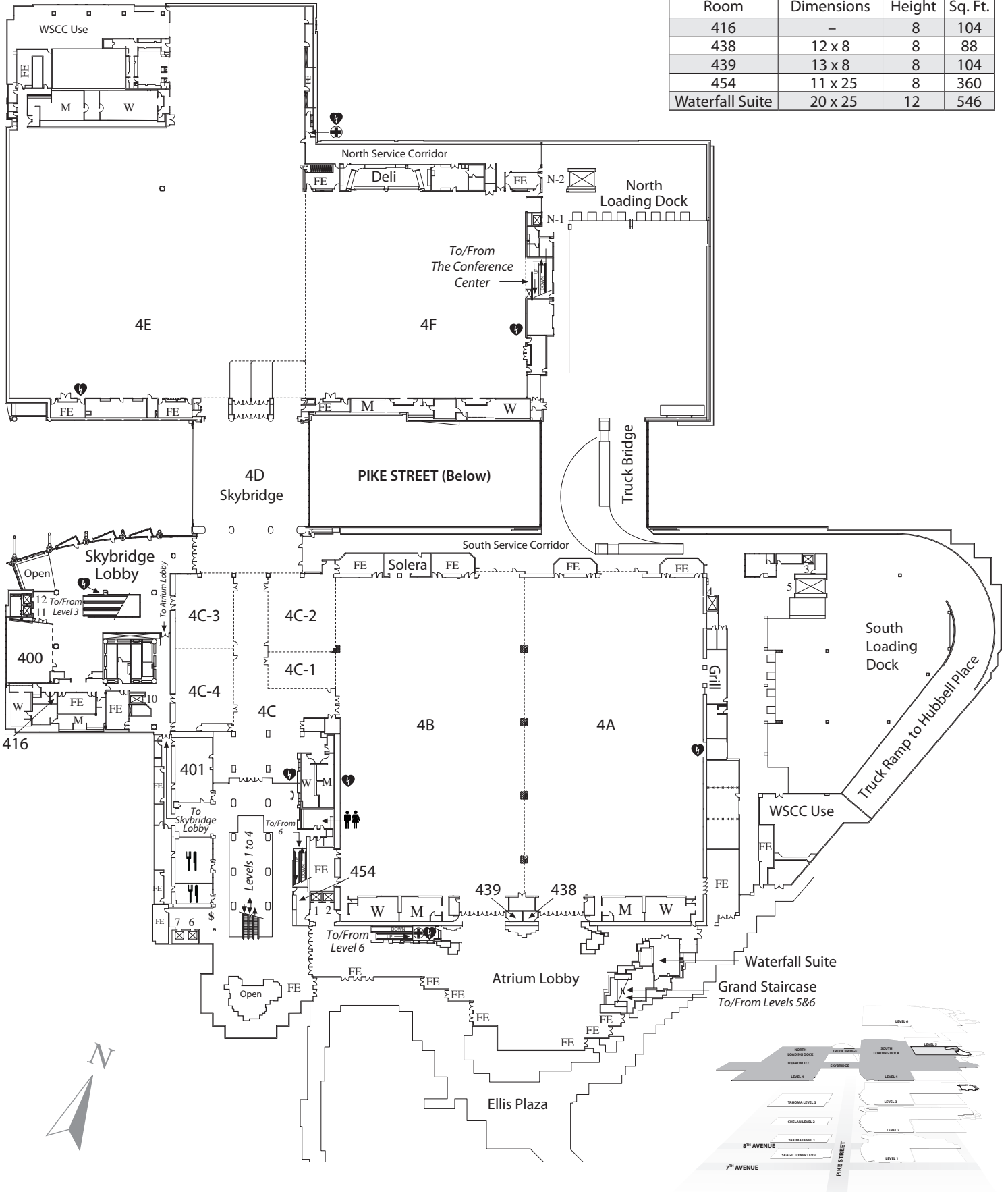

LEVEL 4 - EXHIBITION HALLS

| EXHIBIT HALLS | Square Feet | Square Meter | Dimensions | Height | Theater | Banquet B-10 | Booth 10'x10' | Recommended Front |
|---------------------------|-------------|--------------|-----------------------|--------|---------|--------------|---------------|-------------------|
| Hall 4A | 40,000 | 3,716 | 260 x 143 | 25 | 3,782 | 2,200 | 186 | North |
| Hall 4B | 40,000 | 3,716 | 260 x 149 | 25 | 3,782 | 2,200 | 204 | North |
| Hall 4C ¹ | 20,000 | 1,858 | 131 x 125 | 21 | 1,498 | 1,030 | 73 | North |
| Halls 4AB | 80,000 | 7,432 | 292 x 260 | 25 | 7,365 | 4,400 | 382 | East |
| Halls 4BC | 60,000 | 5,574 | - | 25 | - | - | 272 | |
| Halls 4ABC | 100,000 | 9,290 | - | 25 | - | - | 450 | |
| Atrium Lobby ² | 12,000 | 1,115 | - | 50 | - | 500 | - | |
| Hall 4D ¹ | 10,900 | 1,012 | 86 x 94 | 25 | - | 490 | 42 | North |
| Hall 4E | 64,200 | 5,964 | 242 x 220 + 100 x 110 | 25 | 5,030 | 4,000 | 329 | West |
| Hall 4F | 30,600 | 2,842 | 180 x 170 | 25 | 2,628 | 1,820 | 143 | East |
| Halls 4EF | 94,800 | 8,806 | - | 25 | 8,498 | 6,080 | 487 | West |
| Halls 4DEF | 105,700 | 9,819 | - | 25 | - | - | 515 | |
| Skybridge Lobby | 9,600 | 892 | - | 19 | - | - | - | |
| Halls 4ABCDEF | 205,700 | 19,109 | - | 25 | - | - | 957 | |
| Halls 4BCDEF | 165,700 | 15,393 | - | 25 | - | - | 779 | |
| Halls 4CDEF | 125,700 | 11,677 | - | 25 | - | - | 580 | |

¹4C and 4D dimensions Do Not include entry vestibule. Square feet/meters Do include vestibule.

²Useable square feet is 7,000.

| LEVEL 4 MEETING ROOMS | Square Feet | Dimensions | Height | Theater | Classroom | | Banquet B-10 | Conference | Recommended Front |
|-----------------------|-------------|------------|--------|---------|-----------|-----|--------------|------------|-------------------|
| | | | | | 3pp | 4pp | | | |
| Room 400 | 1,824 | 48 x 38 | 19 | 154 | 66 | 96 | 100 | 56 | South |
| Room 401 | 1,508 | 52 x 29 | 12 | 157 | 64 | 88 | 80 | 48 | North |
| Room 4C-1 | 1,650 | 30 x 55 | 14 | 138 | 54 | 81 | 80 | 54 | East |
| Room 4C-2 | 3,520 | 64 x 55 | 14 | 355 | 140 | 200 | 220 | 80 | South |
| Room 4C-3 | 2,928 | 61 x 48 | 14 | 300 | 117 | 156 | 190 | 72 | South |
| Room 4C-4 | 2,928 | 61 x 48 | 14 | 289 | 108 | 144 | 200 | 72 | North |
| Rooms 4C-1,2 | 5,170 | 94 x 55 | 14 | 570 | 221 | 314 | 320 | - | South |
| Rooms 4C-3,4 | 5,856 | 122 x 48 | 14 | 650 | 258 | 344 | 390 | - | North |

LEVEL 5 - SHOW OFFICES

The floor plan shows a large 'Offices' area on the left. Below it are rooms 504, 505, 506, 507, and 508. To the right are WSCC, Audio rooms, and another WSCC. Below the main office area, there are elevators labeled 'To/From 4 & 6'. The plan also indicates 'Hall 4B (Below)' and 'Hall 4A (Below)'. At the bottom right, there are two human figures and another 'To/From 4 & 6' label with arrows.

| SHOW OFFICES | Square Feet | Dimensions | Height | Conf. |
|---------------|-------------|------------|--------|-------|
| Room 504 | 351 | 27 x 13 | 9 | 8 |
| Room 505 | 364 | 28 x 13 | 9 | 8 |
| Room 506 | 364 | 28 x 13 | 9 | 8 |
| Room 507 | 208 | 16 x 13 | 9 | 8 |
| Room 508 | 260 | 20 x 13 | 9 | 8 |
| Rooms 504-505 | 715 | 55 x 13 | 9 | 16 |
| Rooms 504-506 | 1,079 | 83 x 13 | 9 | 24 |
| Rooms 505-506 | 728 | 56 x 13 | 9 | 16 |

The 3D rendering shows a vertical stack of levels from 1 to 6. Key areas labeled include Skybridge Lobby, Atrium Lobby, Exhibition Halls, and various levels of the building. It also shows the location of 7th Avenue, 8th Avenue, and Pine Street.

LEVEL 6 - BALLROOMS & MEETING ROOMS

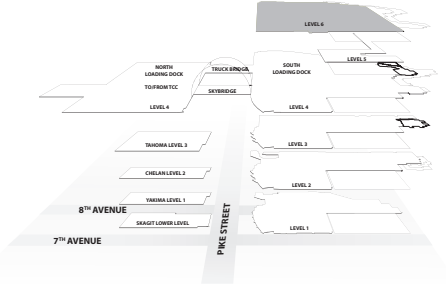

| LEVEL 6 - Support Spaces | | | |
|--------------------------|------------|--------|---------|
| Room | Dimensions | Height | Sq. Ft. |
| Suite A | 12 x 17 | 8 | 209 |
| Suite C | 12 x 12 | 8 | 176 |
| 657 | 11 x 16 | 8 | 192 |

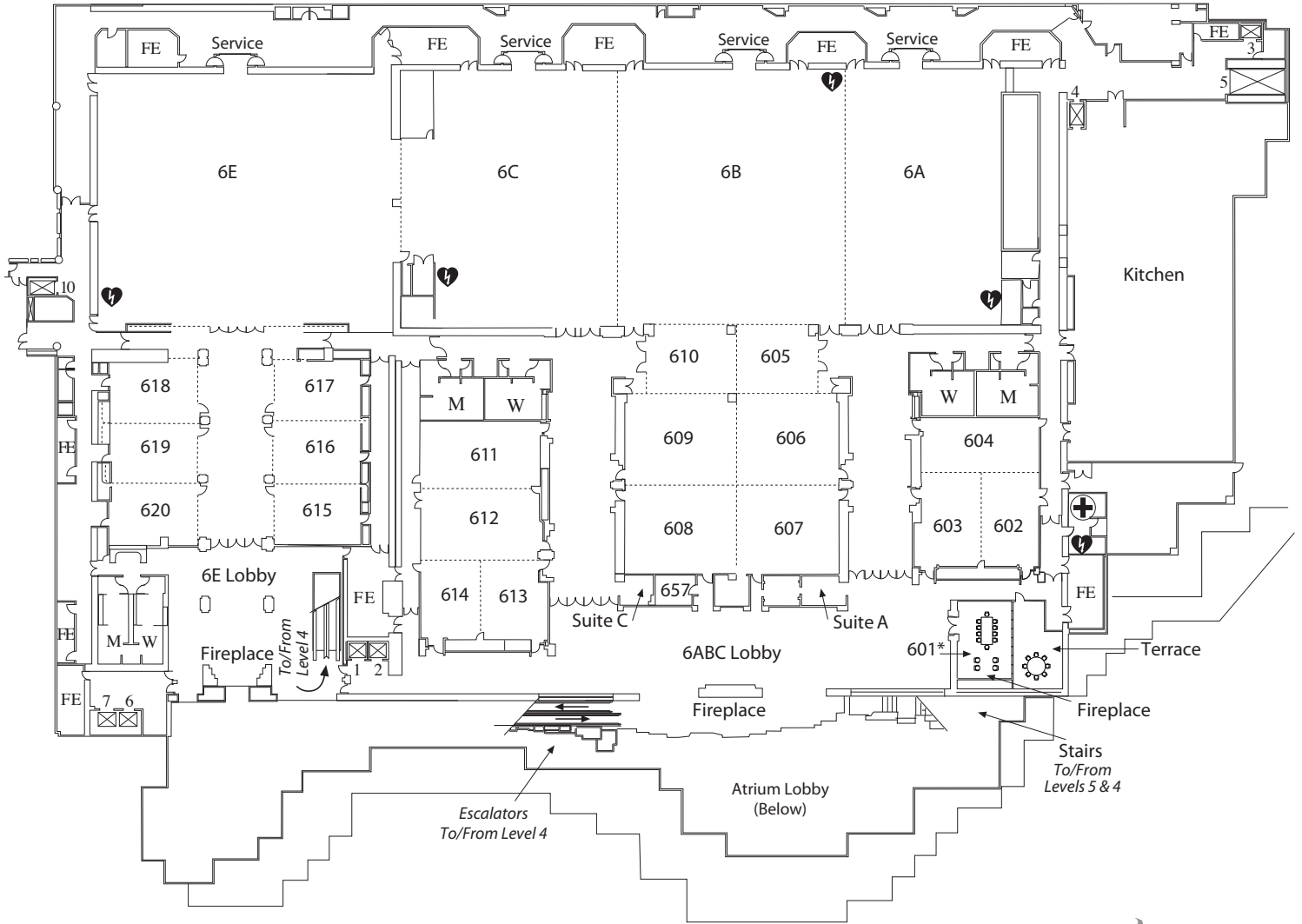

LEVEL 6 – BALLROOMS & MEETING ROOMS

| BALLROOMS | Square Feet | Dimensions | Height | Theater | Classroom | | Banquet B-10 | Booth | | Recommended Front |
|--------------------------|-------------|------------|--------|---------|---------------|---------------|--------------|------------|-------------------|-------------------|
| | | | | | 3pp | 4pp | | 8'x10' | 10'x10' | |
| Ballroom 6A | 8,236 | 116 x 71 | 21 | 810 | 342 | 456 | 540 | 54 | 36 | North |
| Ballroom 6B | 11,500 | 115 x 100 | 21 | 1,118 | 513 | 684 | 720 | 73 | 55 | North |
| Ballroom 6C | 9,628 | 116 x 83 | 21 | 1,023 | 399 | 532 | 660 | 56 | 51 | North |
| Ballroom 6E | 15,048 | 132 x 114 | 21 | 1,500 | 648 | 864 | 990 | 90 | 72 | North |
| Ballrooms 6AB | 19,836 | 171 x 116 | 21 | 2,064 | 912 | 1,216 | 1,260 | 99 | 81 | North |
| Ballrooms 6BC | 21,228 | 183 x 116 | 21 | 2,080 | 1,026 | 1,368 | 1,350 | 122 | 104 | North |
| Ballrooms 6ABC | 29,580 | 255 x 116 | 21 | 3,220 | 1,440 | 1,920 | 1,930 | 154 | 136 | East |
| Ballrooms 6ABC w/605-610 | 39,732 | - | 21/16 | 4,057 | - | 2,440 | 2,380 | 219 | 188 | North |
| Ballrooms 6E w/615-620 | 24,150 | - | 21/14 | - | - | - | 1,390 | 128 | 103 | N/A |
| 6ABC Lobby | 7,700 | - | 16 | - | - | - | - | - | - | |
| 6E Lobby | 3,500 | - | 16 | - | - | - | - | - | - | |
| LEVEL 6 MEETING ROOMS | Square Feet | Dimensions | Height | Theater | Classroom 3pp | Classroom 4pp | Banquet B-10 | Conference | Recommended Front | |
| 601* | 782 | 34 x 23 | 11 | - | - | - | - | 10 | - | |
| 602 | 1,188 | 44 x 27 | 16 | 106 | 42 | 56 | 60 | 44 | North | |
| 603 | 1,144 | 44 x 26 | 16 | 109 | 45 | 62 | 60 | 44 | North | |
| 604 | 1,219 | 53 x 23 | 16 | 113 | 54 | 72 | 80 | 48 | East | |
| 602-603 | 2,332 | 53 x 44 | 16 | 225 | 108 | 144 | 120 | 70 | East | |
| 602-604 | 3,604 | 68 x 53 | 16 | 372 | 165 | 220 | 230 | 88 | North | |
| 605 | 1,110 | 37 x 30 | 16 | 84 | 35 | 50 | 60 | 40 | West | |
| 606 | 1,886 | 46 x 41 | 16 | 158 | 72 | 96 | 110 | 56 | West | |
| 607 | 1,840 | 46 x 40 | 16 | 160 | 72 | 96 | 110 | 56 | South | |
| 608 | 2,000 | 50 x 40 | 16 | 190 | 80 | 112 | 120 | 64 | South | |
| 609 | 2,050 | 50 x 41 | 16 | 188 | 80 | 112 | 120 | 64 | East | |
| 610 | 1,230 | 41 x 30 | 16 | 104 | 42 | 60 | 60 | 48 | East | |
| 605 & 610 | 2,280 | 76 x 30 | 16 | 208 | 95 | 134 | 140 | - | West | |
| 605-606 | 2,996 | - | 16 | 299 | 123 | 164 | 180 | - | South | |
| 605-607 | 4,882 | - | 16 | 496 | 219 | 292 | 270 | - | South | |
| 605-610 | 10,152 | - | 16 | 1,040 | 510 | 696 | 560 | 65 | South | |
| 606-607 | 3,772 | 82 x 46 | 16 | 381 | 168 | 224 | 210 | 96 | South | |
| 606-609 | 7,872 | 96 x 82 | 16 | 835 | 382 | 516 | 540 | - | South | |
| 608-609 | 4,100 | 82 x 50 | 16 | 419 | 168 | 224 | 280 | 102 | South | |
| 608-610 | 5,330 | - | 16 | 541 | 219 | 343 | 330 | - | South | |
| 609-610 | 3,280 | - | 16 | 329 | 123 | 164 | 210 | - | South | |
| 611 | 1,537 | 53 x 29 | 16 | 151 | 54 | 72 | 80 | 54 | West | |
| 612 | 1,643 | 53 x 31 | 16 | 163 | 81 | 108 | 80 | 54 | West | |
| 613 | 1,044 | 36 x 29 | 16 | 92 | 34 | 49 | 60 | 38 | North | |
| 614 | 936 | 36 x 26 | 16 | 77 | 30 | 45 | 60 | 38 | North | |
| 611-612 | 3,233 | 61 x 53 | 16 | 326 | 150 | 200 | 200 | 86 | North | |
| 611-614 | 5,194 | 98 x 53 | 16 | 571 | 255 | 340 | 320 | - | North | |
| 612-614 | 3,604 | 68 x 53 | 16 | 355 | 165 | 220 | 200 | - | North | |
| 613-614 | 2,016 | 56 x 36 | 16 | 182 | 81 | 108 | 120 | 62 | West | |
| 615 | 1,014 | 39 x 26 | 14 | 96 | 36 | 54 | 60 | 40 | East | |
| 616 | 1,092 | 39 x 28 | 14 | 96 | 36 | 54 | 60 | 40 | East | |
| 617 | 1,053 | 39 x 27 | 14 | 96 | 36 | 54 | 60 | 40 | East | |
| 618 | 1,053 | 39 x 27 | 14 | 98 | 36 | 54 | 60 | 40 | West | |
| 619 | 1,092 | 39 x 28 | 14 | 99 | 36 | 54 | 60 | 40 | West | |
| 620 | 1,014 | 39 x 26 | 14 | 96 | 36 | 52 | 60 | 40 | West | |
| 615-616 | 2,145 | 55 x 39 | 14 | 208 | 90 | 126 | 120 | 64 | North | |
| 615-617 | 3,198 | 82 x 39 | 14 | 325 | 140 | 196 | 210 | 88 | North | |
| 615-620 | 9,102 | 111 x 82 | 14 | - | - | - | 500 | 44 | N/A | |
| 616-617 | 2,184 | 56 x 39 | 14 | 213 | 90 | 126 | 120 | 64 | North | |
| 618-619 | 2,145 | 55 x 39 | 14 | 213 | 90 | 126 | 120 | 64 | North | |
| 618-620 | 3,198 | 82 x 39 | 14 | 322 | 138 | 193 | 200 | 88 | North | |
| 619-620 | 2,106 | 54 x 39 | 14 | 195 | 90 | 126 | 120 | 64 | North | |

* Permanent Set

THE CONFERENCE CENTER

Skagit Lower Level

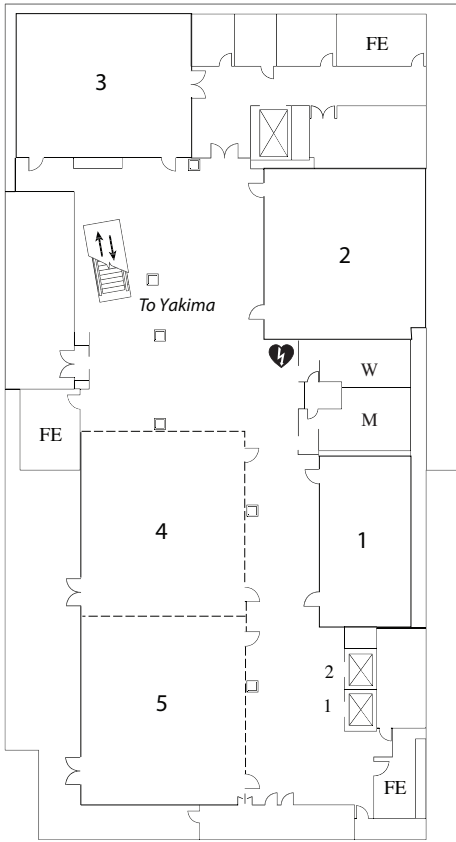

Yakima Level 1

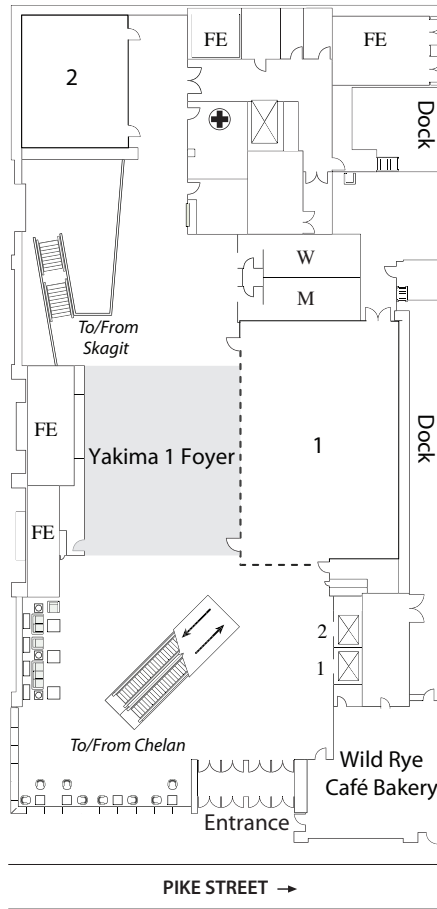

Chelan Level 2

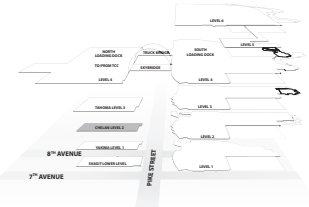
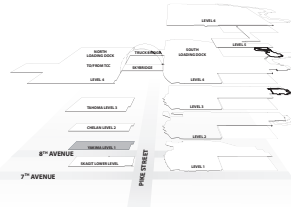
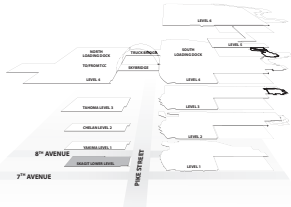
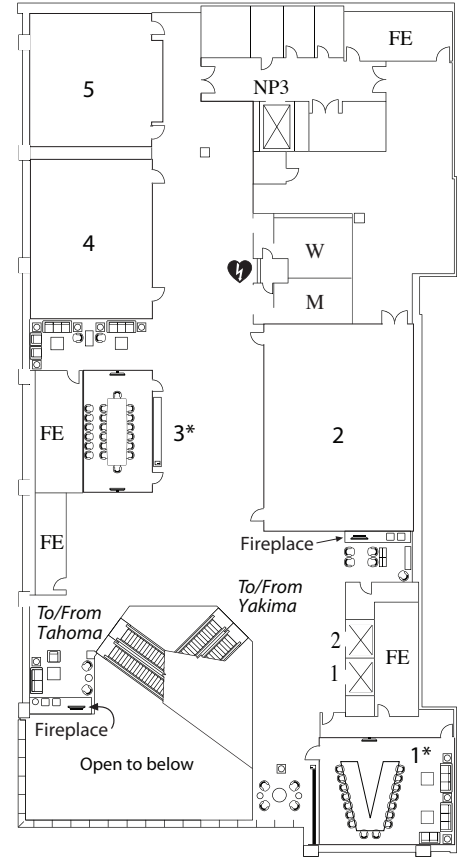

| MEETING ROOMS | Square Feet | Dimensions | Height | Theater | Classroom | | Banquet | Conference | Recommended Front |
|---------------|-------------|------------|--------|---------|-----------|-----|---------|------------|-------------------|
| | | | | | 3pp | 4pp | | | |
| Skagit 1 | 966 | 42 x 23 | 12 | 90 | 36 | 48 | 60 | 40 | South |
| Skagit 2 | 1,763 | 43 x 41 | 14 | 171 | 72 | 96 | 90 | 56 | East |
| Skagit 3 | 1,575 | 45 x 35 | 14 | 133 | 56 | 84 | 90 | 52 | North |
| Skagit 4 | 1,927 | 47 x 41 | 14 | 180 | 72 | 108 | 120 | 64 | West |
| Skagit 5 | 1,968 | 48 x 41 | 14 | 180 | 72 | 108 | 120 | 64 | South |
| Skagit 4-5 | 3,936 | 96 x 41 | 14 | 391 | 160 | 224 | 240 | - | South |

| | | | | | | | | | |
|------------------|-------|----------|--------|-----|-----|-----|-----|----|-------|
| Yakima 1 | 2,838 | 66 x 43 | 10' 4" | 281 | 129 | 173 | 150 | 78 | North |
| Yakima 1 + Foyer | 4,875 | 113 x 43 | 10' 4" | - | - | - | - | - | |
| Yakima 2 | 1,008 | 36 x 28 | 10' 6" | 84 | 35 | 50 | 60 | 38 | North |

| | | | | | | | | | |
|-----------|-------|---------|------|-----|----|-----|-----|----|-------|
| Chelan 1* | 1,170 | 39 x 30 | 9'6" | - | - | - | - | 16 | North |
| Chelan 2 | 2,090 | 55 x 38 | 9'3" | 197 | 90 | 126 | 120 | 56 | North |
| Chelan 3* | 640 | 32 x 20 | 9'6" | - | - | - | - | 14 | North |
| Chelan 4 | 1,344 | 42 x 32 | 9'6" | 114 | 54 | 72 | 60 | 46 | North |
| Chelan 5 | 1,225 | 35 x 35 | 9'6" | 97 | 45 | 60 | 60 | 40 | North |

* Chelan 1* and 3* each feature an executive conference table and are a permanent set.

THE CONFERENCE CENTER

Tahoma Level 3

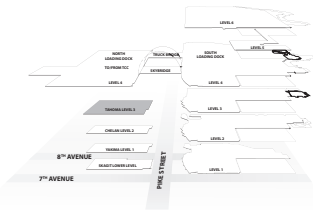
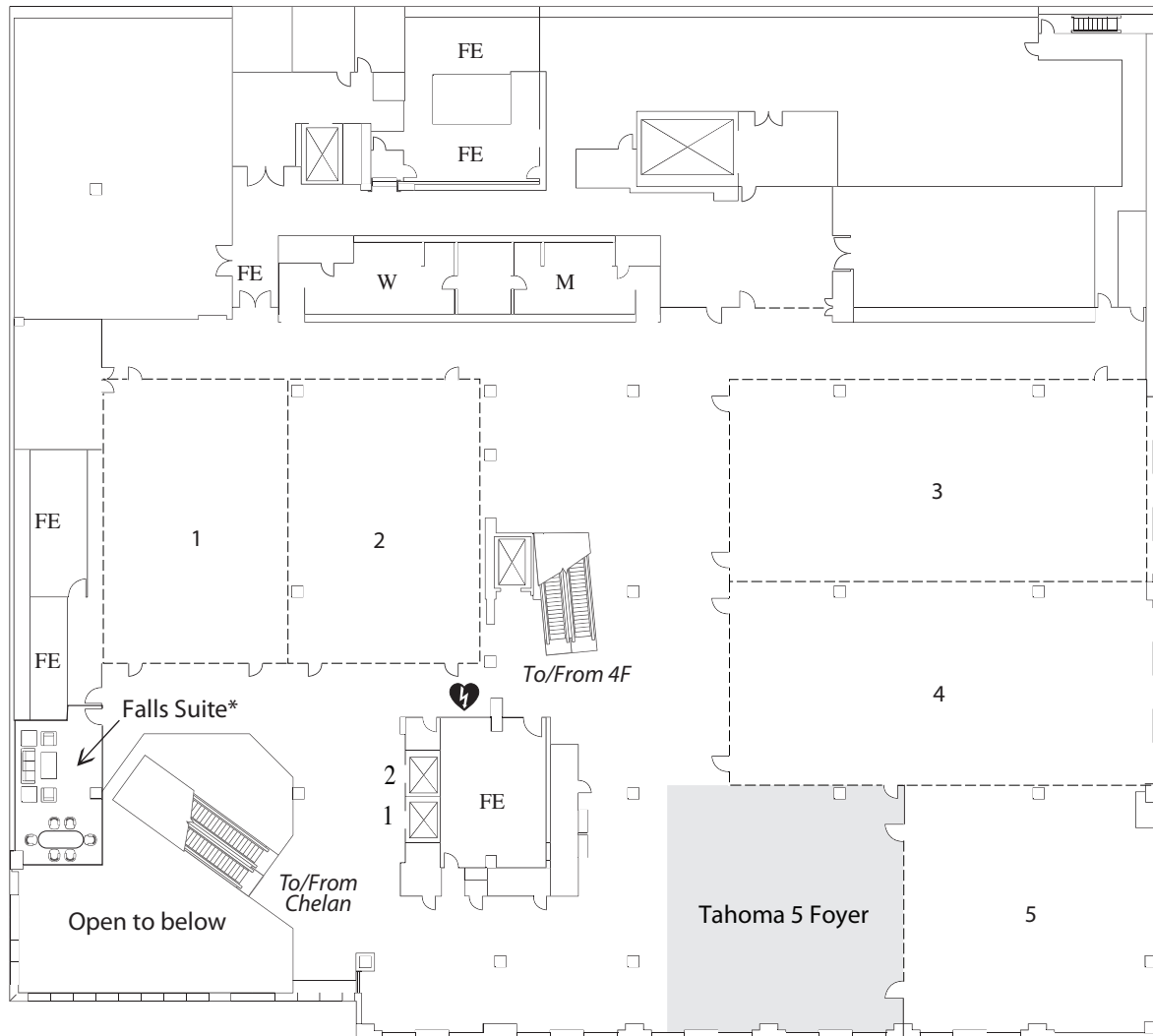

| MEETING ROOMS | Square Feet | Dimensions | Height | Theater | Classroom | | Banquet | Conference | Recommended Front |
|-------------------------|-------------|---|--------|---------|-----------|-----|---------|------------|-------------------|
| | | | | | 3pp | 4pp | | | |
| Tahoma 1 | 2,542 | 62 x 41 | 15 | 224 | 100 | 140 | 150 | 72 | North |
| Tahoma 2 | 2,604 | 62 x 42 | 15 | 240 | 112 | 152 | 150 | 72 | North |
| Tahoma 1-2 | 5,208 | 62 x 84 | 15 | 485 | 234 | 312 | 330 | - | North |
| Tahoma 3 | 4,136 | 94 x 44 | 13 | 408 | 198 | 266 | 240 | 104 | East |
| Tahoma 4 | 4,136 | 94 x 44 | 14 | 408 | 198 | 266 | 240 | 104 | East |
| Tahoma 3-4 | 8,366 | 94 x 89 | 13 | 828 | 396 | 528 | 520 | - | North |
| Tahoma 5 | 2,856 | 56 x 51 | 15 | 303 | 126 | 180 | 160 | 72 | East |
| Tahoma 5 + Foyer | 5,916 | 116 x 51 | 15 | - | - | - | - | - | |
| Falls Suite* | 558 | 18 x 31 | 9 | - | - | - | - | 6 | |
| Tahoma as Exhibit Space | 31,000 | Tahoma Level 3 can accommodate a total of (124) 10'x10' booths and (2) 8'x10' booths. | | | | | | | |

* Permanent Set

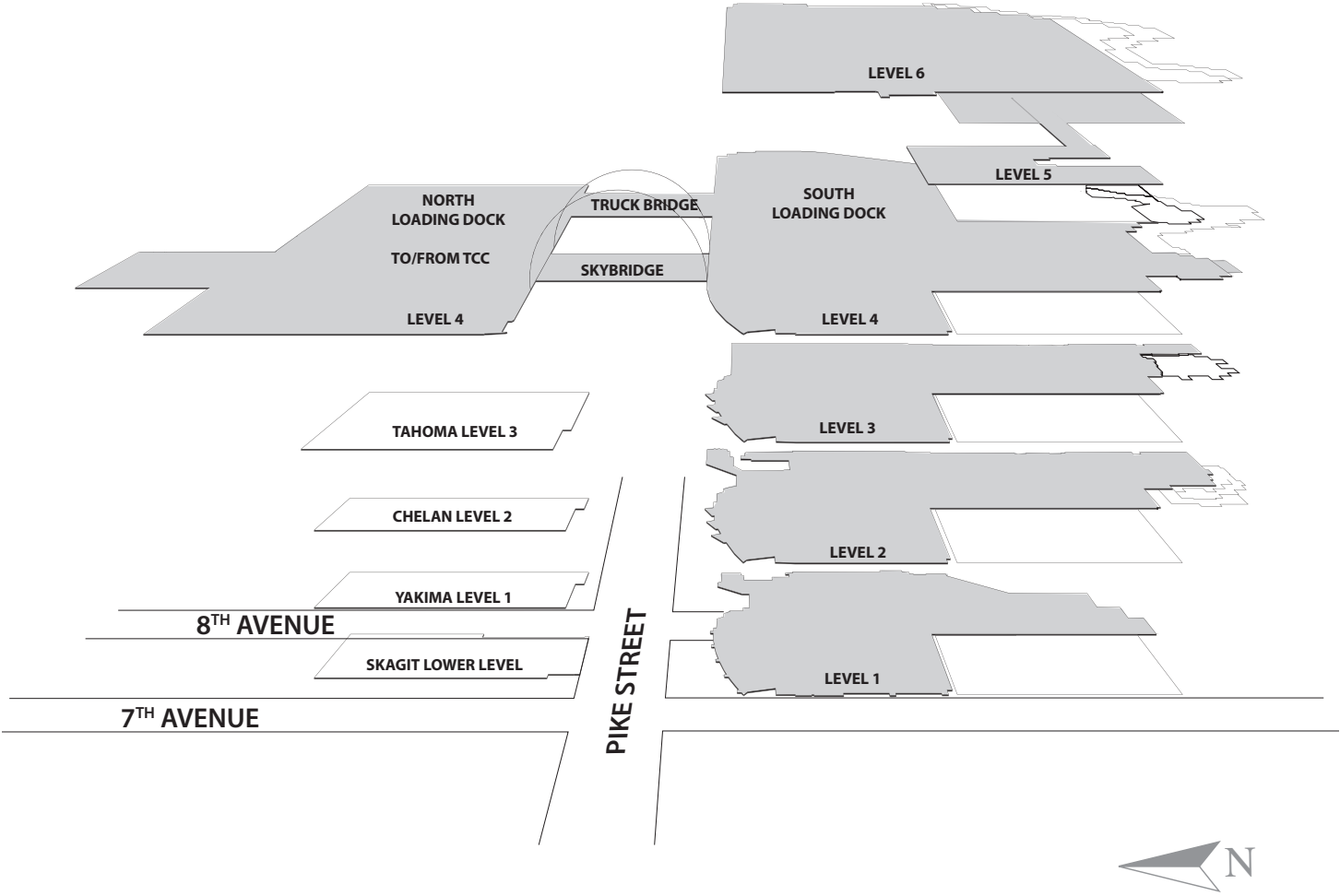

NOTES

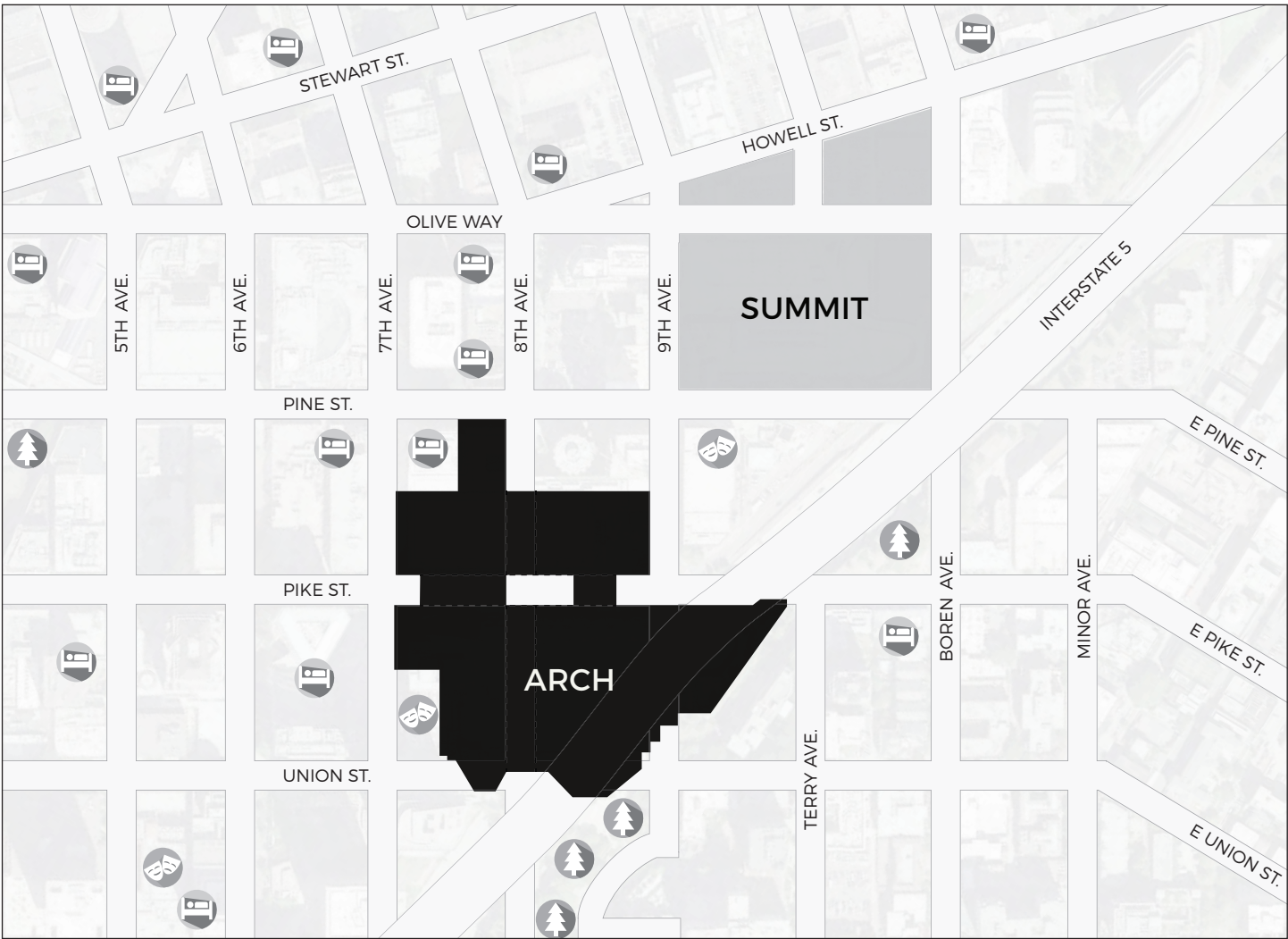

NOTES









ROOM SET CAPACITY

General Room Set Standards

- Sample maximum set room diagrams are available upon request
- Complimentary water coolers are provided in all meeting room sets
- Complimentary bottled water placed on all lecterns, head tables, and conference sets
- Notepads, pens, and candy dishes placed on meeting table sets of less than 250
- Complimentary linen on classroom, conference style, and meetings set at round tables
- Complimentary table skirts on head tables and classroom aisles
- One midday and overnight room refresh is included with set
- Overnight set changes are complimentary with sufficient notice
- Daytime set changes will incur labor charges, except to support a significant F & B function
- Stage risers are not generally set in rooms with ceiling heights less than 12' or non-combined meeting rooms
- Maximum listed capacities will be reduced by optional peripheral equipment such as stages, audio visual equipment, catering services, etc.
- All Exhibit, General Session, and Registration layouts are subject to Fire Code review

| | |
|---|---|
| <p><u>Chair dimensions:</u></p> <ul style="list-style-type: none"> • WSCC Chairs: 21" wide x 19" deep • TCC Chairs: 19½" wide x 19" deep | <p><u>Theater:</u></p> <ul style="list-style-type: none"> • Maximum of 15 chairs per row (before aisle) • Maximum 15 rows (before aisle) • 20" space between rows (leg to leg) |
| <p><u>Classroom:</u></p> <ul style="list-style-type: none"> • Maximum of 3 tables per row (before aisle) • Maximum 15 rows (before aisle) • 8' x 18' tables as standard • 1 chair per 2' of table • 36" space between tables | <p><u>Banquet:</u></p> <ul style="list-style-type: none"> • 72" rounds • 10 chairs per table • 11' centers-spacing between tables • Straight row layout as standard, staggered sets not preferred |
| <p><u>Conference:</u></p> <ul style="list-style-type: none"> • Conference maximum capacity may be set as board or hollow square, depending on room size • 8'x 30" tables as standard • 1 chair per 2' of table | <p><u>Riser Specifications:</u></p> <ul style="list-style-type: none"> • Safety rails are required on all stage risers • 6'x 8' sections • 16", 24", 32", 40" heights • Installation fee will apply for 40" units or sets exceeding 12 units • Subject to available inventory |
| <p><u>Front of Room allowance in capacity counts:</u></p> <ul style="list-style-type: none"> • Front wall to first row for Theater and Classroom sets: <ul style="list-style-type: none"> <li style="width: 50%;">- Single meeting rooms - 10 ft <li style="width: 50%;">- Ballrooms 6ABCE & Hall 4C - 20 ft <li style="width: 50%;">- Combined meeting rooms - 13 ft <li style="width: 50%;">- Exhibit Halls 4AB & 4DEF - 40 ft • No front of room allowance in Banquet or Conference sets | |

LEGEND

| | | | |
|--|--|---|--|
|  AED Device |  Cash Machine |  Food/Beverage |  Accessible Entrance Lift |
|  Fire Exit |  Gender-Neutral Restrooms |  First Aid |  Seattle Visitor Center |