

Floor Plans, Capacities, and Dimensions

Arch



Facility Overview

OVERVIEW	SQUARE FEET
Total Exhibit Space	205,700
70 Meeting Rooms	93,692
4 Ballrooms	44,628
Total Lobby Area	78,680
Special Event Space	9,711
Support Space	2,577
Total Event Space	434,988

Level 1 – Entrance (main entrance)

- Retail, business center, food outlets, restrooms, and access to all event space
- Two special event spaces, totaling 3,711 square feet

Level 2 – Meeting Rooms

- 14 individual meeting rooms ranging from 602 to 1,786 square feet, totaling 15,841 square feet
- Including two executive conference rooms

Level 3 – Meeting Rooms

- 12 individual meeting rooms ranging from 450 to 1,786 square feet, totaling 11,687 square feet
- Including an executive conference room
- Public access to parking garage

Level 4 – Exhibit Hall

- 205,700 square feet of exhibit space with 25-foot ceilings
- Divisible into six halls with four separate entrances from three separate pre-function areas
- Loading area with 19 bays, two 20,000 lb freight elevators, two 4,500 lb service elevators
- Multiple show office options with three overlooking the exhibit hall
- 6,000 square foot outdoor plaza adjacent to 12,000 square foot lobby

Level 6 – Meeting Rooms

- 20 individual meeting rooms ranging from 782 to 2,050 square feet, totaling 28,834 square feet
- Including an executive conference room with a private outdoor terrace
- Approximately 20,000 square feet of lobby and common space

Level 6 – Ballrooms

- A 29,580 square-foot column-free ballroom with 21-foot ceiling
- A 15,048 square foot column-free ballroom with 21-foot ceiling
- Ballrooms can combine

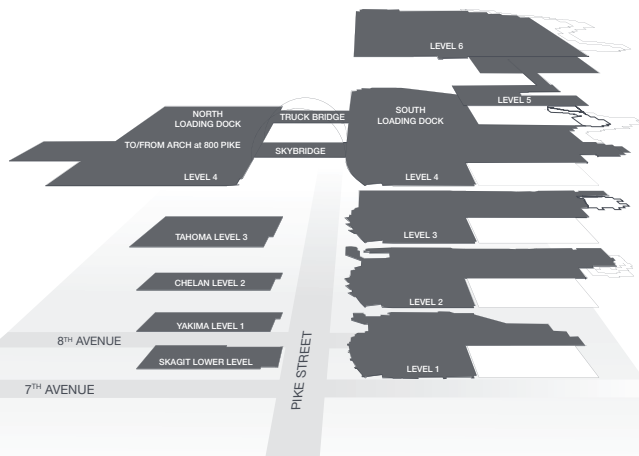

Level 1 – Entrances, Shops, & Services

Arch at 800 Pike

See page 10

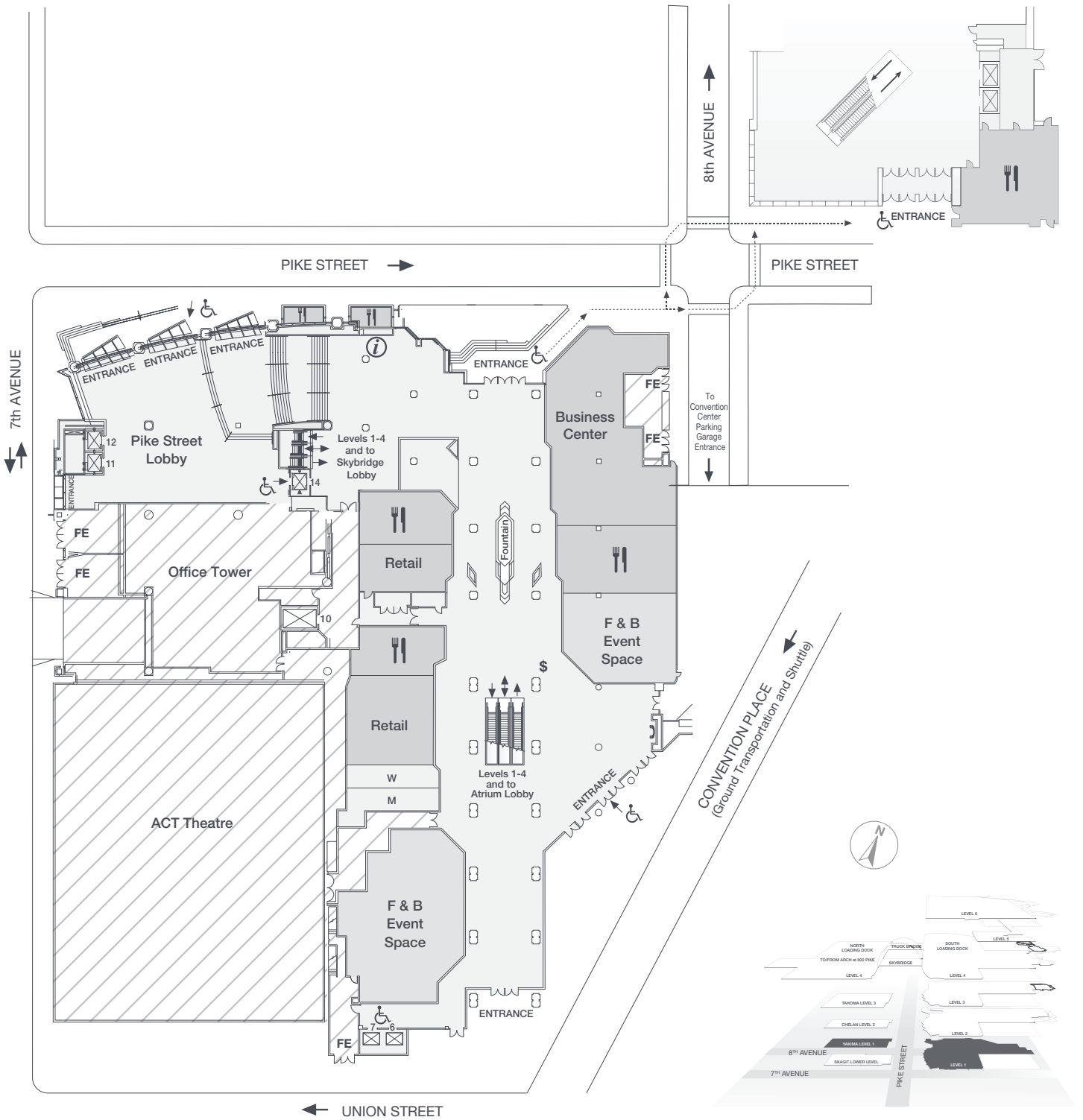

Arch at 705 Pike

Level 2 – Meeting Rooms

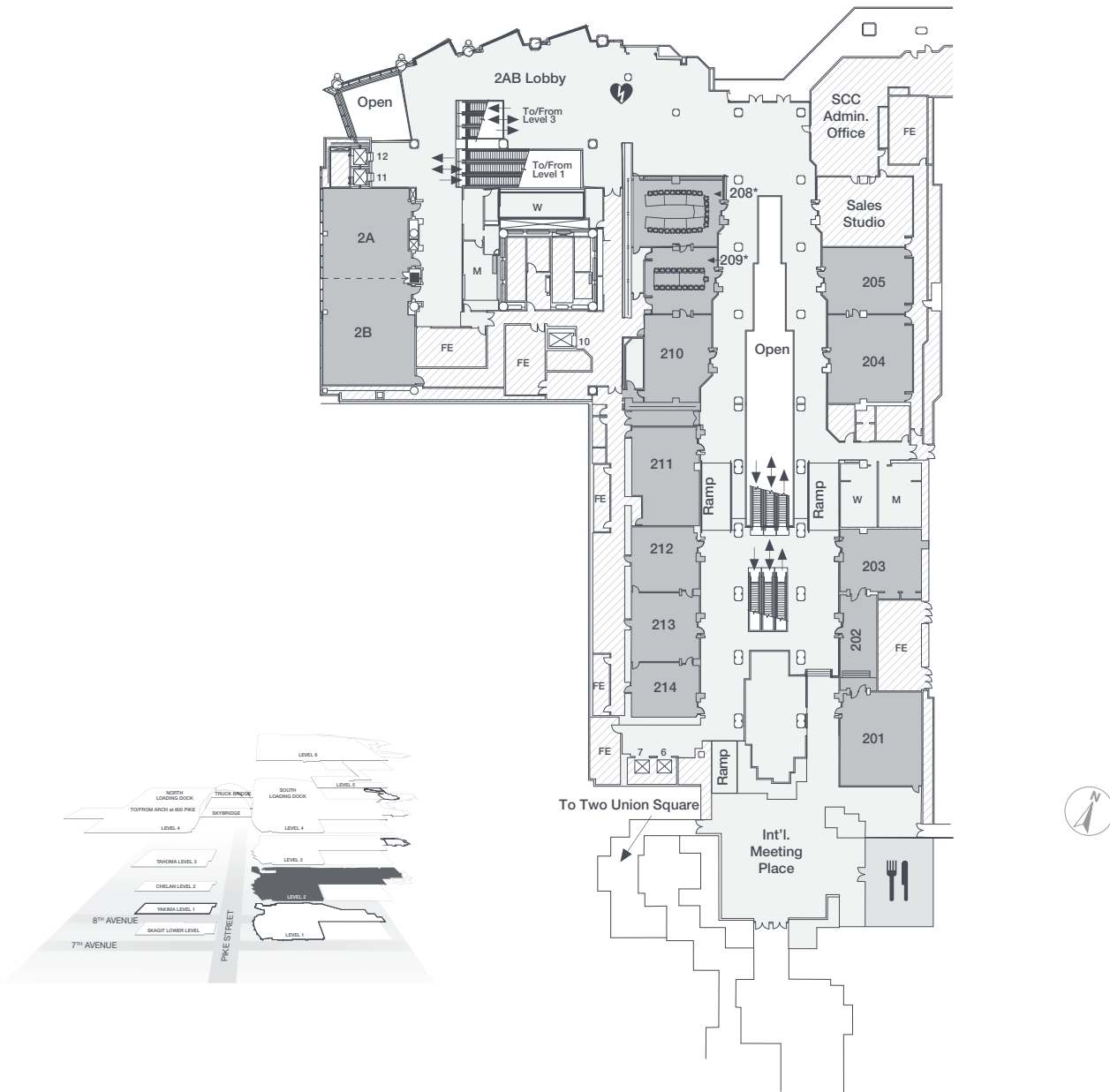

LEVEL 2 ROOMS	SQUARE FEET	DIMENSIONS	HEIGHT	THEATER	CLASSROOM 3PP	CLASSROOM 4PP	BANQUET B-10	CONFERENCE	RECOMMENDED FRONT
Room 201	1,435	35 x 41	8'6"	147	63	84	90	48	South
Room 202	602	43 x 14	9	35	15	20	20	28	South
Room 203	1,044	36 x 29	9	81	30	45	50	36	East
Room 204	1,443	39 x 37	9	119	45	65	80	44	East
Room 205	1,073	37 x 29	8'11"	96	34	51	60	38	East
Room 208*	1,160	40 x 29	9	-	-	-	-	26	West
Room 209*	928	32 x 29	8'10"	-	-	-	-	20	West
Room 210	1,170	39 x 30	9	70	35	50	42	24	South
Room 211	1,247	43 x 30	9	119	42	63	70	38	South
Room 212	812	29 x 28	9	65	24	36	40	32	South
Room 213	840	30 x 28	9	70	27	39	40	32	North
Room 214	780	30 x 26	9	56	24	32	40	26	North
Room 2A	1,521	39 x 39	13	135	58	82	90	48	South
Room 2B	1,786	47 x 38	13	175	69	97	110	56	South
Rooms 2AB	3,393	87 x 39	13	325	142	201	210	96	South

* Permanent Set

Level 3 – Meeting Rooms

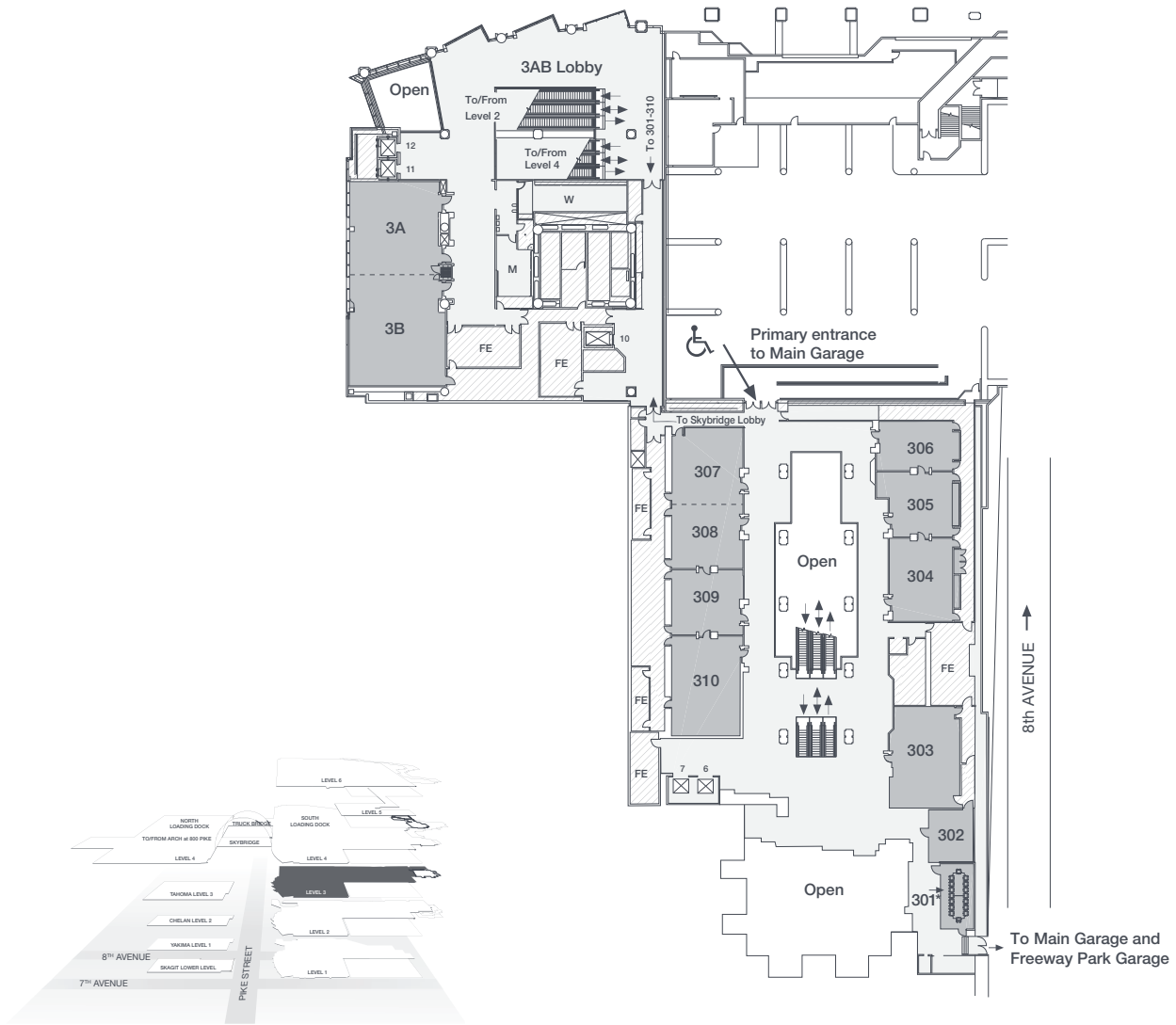

LEVEL 3 ROOMS	SQUARE FEET	DIMENSIONS	HEIGHT	THEATER	CLASSROOM		BANQUET	CONFERENCE	RECOMMENDED FRONT
					3PP	4PP			
Room 301*	450	30 x 15	8'5"	-	-	-	-	16	-
Room 302	460	23 x 20	8'5"	30	8	12	20	18	South
Room 303	1,305	45 x 29	9	117	54	74	70	46	South
Room 304	918	34 x 27	9	79	30	40	60	32	North
Room 305	840	30 x 28	9'6"	55	24	32	40	24	East
Room 306	714	34 x 21	9'6"	53	20	30	30	30	East
Room 307	841	29 x 29	10	67	29	40	40	30	North
Room 308	812	28 x 29	10	61	24	32	40	30	West
Rooms 307-308	1,653	57 x 29	10	156	63	90	80	56	North
Room 309	840	28 x 29	10	56	25	36	40	28	West
Room 310	1,200	40 x 30	10	96	42	60	60	40	South
Room 3A	1,521	40 x 39	12	135	58	82	90	48	South
Room 3B	1,786	47 x 38	12	175	69	97	110	56	South
Rooms 3AB	3,393	87 x 39	12	325	142	201	210	96	South

* Permanent Set

Level 4 – Exhibition Halls

LEVEL 4 – SUPPORT SPACES

ROOM	DIMENSIONS	HEIGHT	SQ. FT.
416	–	8	104
438	12 x 8	8	88
439	13 x 8	8	104
454	11 x 25	8	360
Waterfall Suite	20 x 25	12	546

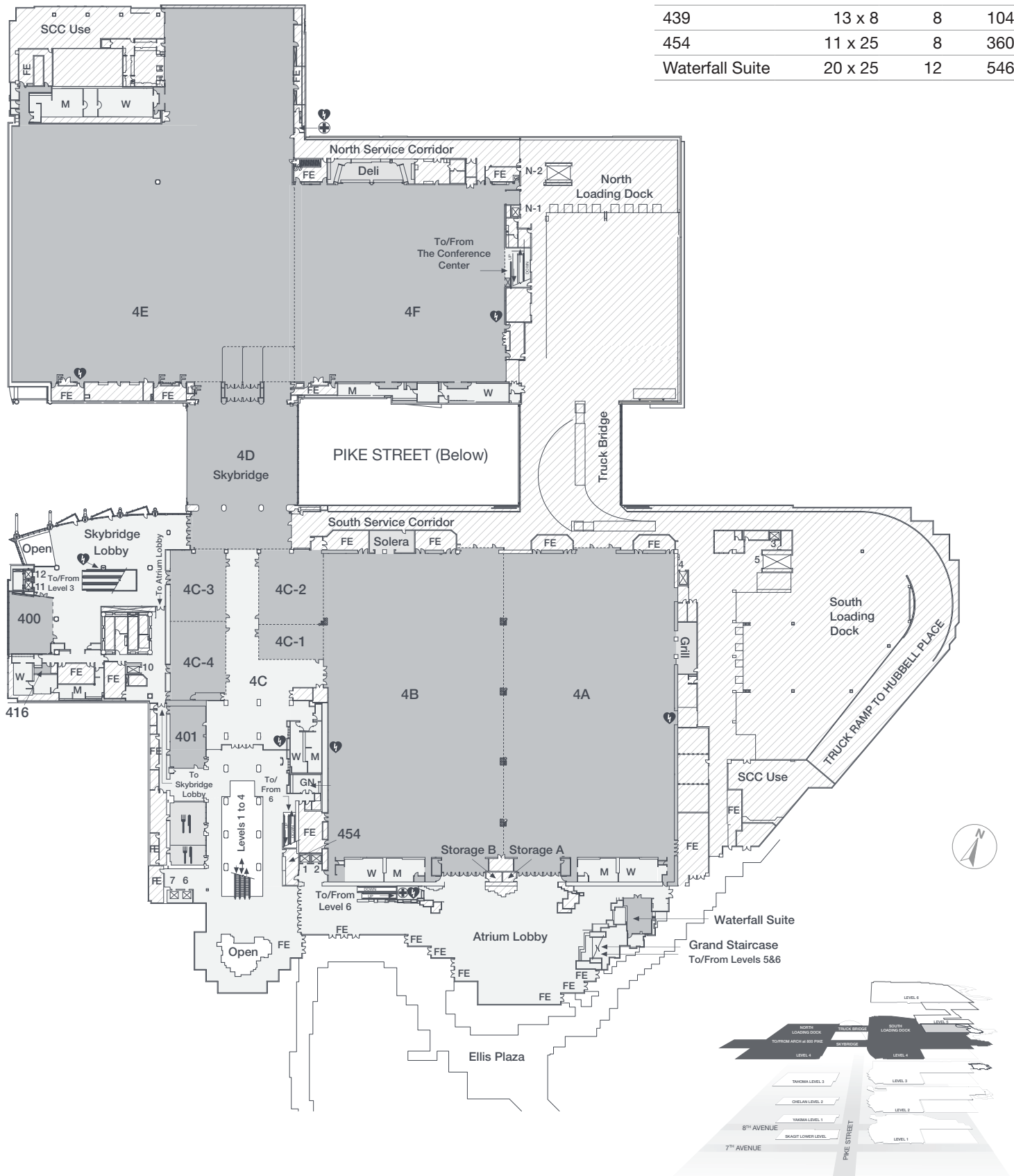

Level 4 – Exhibition Halls

EXHIBIT HALLS	SQUARE FEET	SQUARE METER	DIMENSIONS	HEIGHT	THEATER	BANQUET B-10	BOOTH 10'X10'	RECOMMENDED FRONT
Hall 4A	40,000	3,716	260 x 143	25	3,782	2,200	186	North
Hall 4B	40,000	3,716	260 x 149	25	3,782	2,200	204	North
Hall 4C ¹	20,000	1,858	131 x 125	21	1,498	1,030	73	North
Halls 4AB	80,000	7,432	292 x 260	25	7,365	4,400	382	East
Halls 4BC	60,000	5,574	-	25	-	-	272	
Halls 4ABC	100,000	9,290	-	25	-	-	450	
Atrium Lobby ²	12,000	1,115	-	50	-	500	-	
Hall 4D ¹	10,900	1,012	86 x 94	25	-	490	42	North
Hall 4E	64,200	5,964	242 x 220 + 100 x 110	25	5,030	4,000	329	West
Hall 4F	30,600	2,842	180 x 170	25	2,628	1,820	143	East
Halls 4EF	94,800	8,806	-	25	8,498	6,080	487	West
Halls 4DEF	105,700	9,819	-	25	-	-	515	
Skybridge Lobby	9,600	892	-	19	-	-	-	
Halls 4ABCDEF	205,700	19,109	-	25	-	-	957	
Halls 4BCDEF	165,700	15,393	-	25	-	-	779	
Halls 4CDEF	125,700	11,677	-	25	-	-	580	

14C and 4D dimensions DO NOT include entry vestibule. Square feet/meters DO include vestibule.

2 Useable square feet is 7,000.

LEVEL 4 MEETING ROOMS	SQUARE FEET	DIMENSIONS	HEIGHT	THEATER	CLASSROOM 3PP	4PP	BANQUET B-10	CONFERENCE	RECOMMENDED FRONT
Room 400	1,824	48 x 38	19	154	66	96	100	56	South
Room 401	1,508	52 x 29	12	157	64	88	80	48	North
Room 4C-1	1,650	30 x 55	14	138	54	81	80	54	East
Room 4C-2	3,520	64 x 55	14	355	140	200	220	80	South
Room 4C-3	2,928	61 x 48	14	300	117	156	190	72	South
Room 4C-4	2,928	61 x 48	14	289	108	144	200	72	North
Rooms 4C-1,2	5,170	94 x 55	14	570	221	314	320	-	South
Rooms 4C-3,4	5,856	122 x 48	14	650	258	344	390	-	North

Level 5 – Show Offices

SHOW OFFICES SQUARE FEET DIMENSIONS HEIGHT CONF.

Room 504	351	27 x 13	9	8
Room 505	364	28 x 13	9	8
Room 506	364	28 x 13	9	8
Room 507	208	16 x 13	9	8
Room 508	260	20 x 13	9	8
Rooms 504-505	715	55 x 13	9	16
Rooms 504-506	1,079	83 x 13	9	24
Rooms 505-506	728	56 x 13	9	16

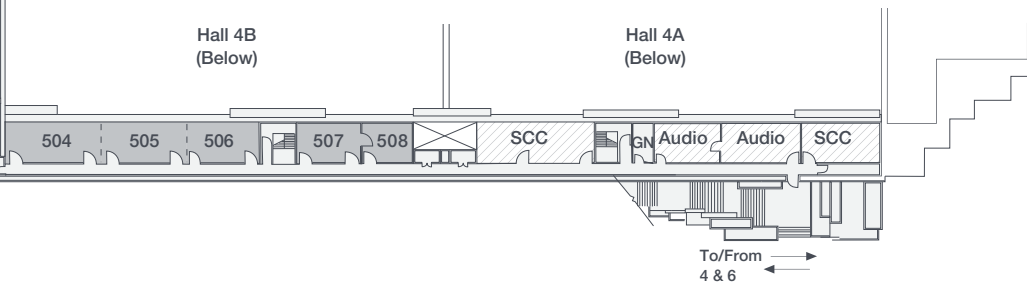
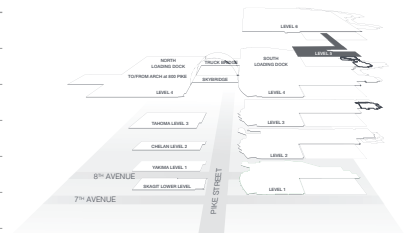
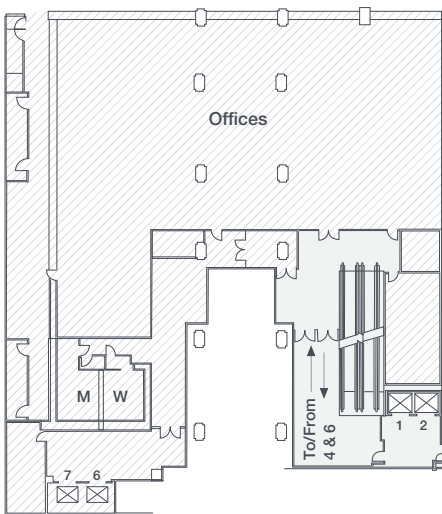

Level 6 – Ballrooms & Meeting Rooms

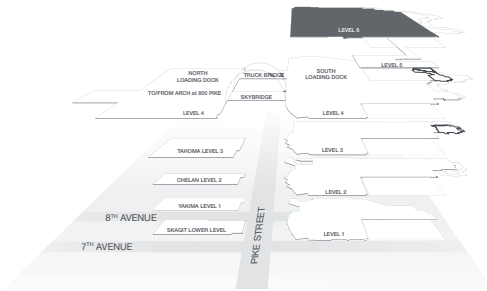

LEVEL 6 – SUPPORT SPACES

ROOM	DIMENSIONS	HEIGHT	SQ. FT.
Suite A	12 x 17	8	209
Suite C	12 x 12	8	176
657	11 x 16	8	192

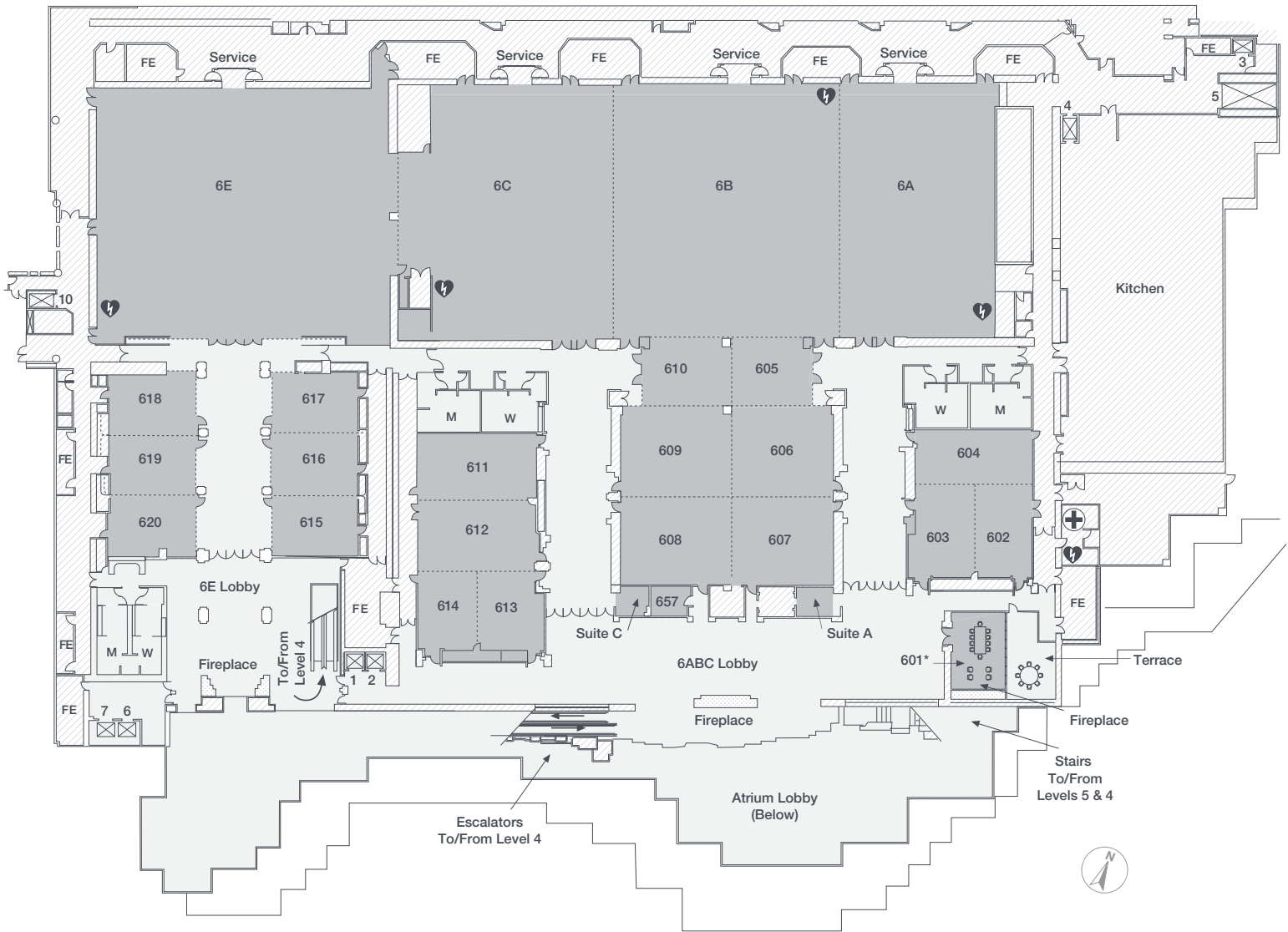

Level 6 – Ballrooms & Meeting Rooms

BALLROOMS	SQUARE FEET	DIMENSIONS	HEIGHT	THEATER	CLASSROOM		BANQUET B-10	BOOTH 8'X10'	BOOTH 10'X10'	RECOMMENDED FRONT
					3PP	4PP				
Ballroom 6A	8,236	116 x 71	21	810	342	456	540	54	36	North
Ballroom 6B	11,500	115 x 100	21	1,118	513	684	720	73	55	North
Ballroom 6C	9,628	116 x 83	21	1,023	399	532	660	56	51	North
Ballroom 6E	15,048	132 x 114	21	1,500	648	864	990	90	72	North
Ballrooms 6AB	19,836	171 x 116	21	2,064	912	1,216	1,260	99	81	North
Ballrooms 6BC	21,228	183 x 116	21	2,080	1,026	1,368	1,350	122	104	North
Ballrooms 6ABC	29,580	255 x 116	21	3,220	1,440	1,920	1,930	154	136	East
Ballrooms 6ABC w/605-610	39,732	-	21/16	4,057	-	2,440	2,380	219	188	North
Ballrooms 6E w/615-620	24,150	-	21/14	-	-	-	1,390	128	103	N/A
6ABC Lobby	7,700	-	16	-	-	-	-	-	-	-
6E Lobby	3,500	-	16	-	-	-	-	-	-	-

LEVEL 6 MEETING ROOMS	SQUARE FEET	DIMENSIONS	HEIGHT	THEATER	CLASSROOM		BANQUET B-10	CONFERENCE	RECOMMENDED FRONT
					3PP	4PP			
601*	782	34 x 23	11	-	-	-	-	10	-
602	1,188	44 x 27	16	106	42	56	60	44	North
603	1,144	44 x 26	16	109	45	62	60	44	North
604	1,219	53 x 23	16	113	54	72	80	48	East
602-603	2,332	53 x 44	16	225	108	144	120	70	East
602-604	3,604	68 x 53	16	372	165	220	230	88	North
605	1,110	37 x 30	16	84	35	50	60	40	West
606	1,886	46 x 41	16	158	72	96	110	56	West
607	1,840	46 x 40	16	160	72	96	110	56	South
608	2,000	50 x 40	16	190	80	112	120	64	South
609	2,050	50 x 41	16	188	80	112	120	64	East
610	1,230	41 x 30	16	104	42	60	60	48	East
605 & 610	2,280	76 x 30	16	208	95	134	140	-	West
605-606	2,996	-	16	299	123	164	180	-	South
605-607	4,882	-	16	496	219	292	270	-	South
605-610	10,152	-	16	1,040	510	696	560	65	South
606-607	3,772	82 x 46	16	381	168	224	210	96	South
606-609	7,872	96 x 82	16	835	382	516	540	-	South
608-609	4,100	82 x 50	16	419	168	224	280	102	South
608-610	5,330	-	16	541	219	343	330	-	South
609-610	3,280	-	16	329	123	164	210	-	South
611	1,537	53 x 29	16	151	54	72	80	54	West
612	1,643	53 x 31	16	163	81	108	80	54	West
613	1,044	36 x 29	16	92	34	49	60	38	North
614	936	36 x 26	16	77	30	45	60	38	North
611-612	3,233	61 x 53	16	326	150	200	200	86	North
611-614	5,194	98 x 53	16	571	255	340	320	-	North
612-614	3,604	68 x 53	16	355	165	220	200	-	North
613-614	2,016	56 x 36	16	182	81	108	120	62	West
615	1,014	39 x 26	14	96	36	54	60	40	East
616	1,092	39 x 28	14	96	36	54	60	40	East
617	1,053	39 x 27	14	96	36	54	60	40	East
618	1,053	39 x 27	14	98	36	54	60	40	West
619	1,092	39 x 28	14	99	36	54	60	40	West
620	1,014	39 x 26	14	96	36	52	60	40	West
615-616	2,145	55 x 39	14	208	90	126	120	64	North
615-617	3,198	82 x 39	14	325	140	196	210	88	North
615-620	9,102	111 x 82	14	-	-	-	500	44	N/A
616-617	2,184	56 x 39	14	213	90	126	120	64	North
618-619	2,145	55 x 39	14	213	90	126	120	64	North
618-620	3,198	82 x 39	14	322	138	193	200	88	North
619-620	2,106	54 x 39	14	195	90	126	120	64	North

* Permanent Set

Arch at 800 Pike

Skagit Lower Level

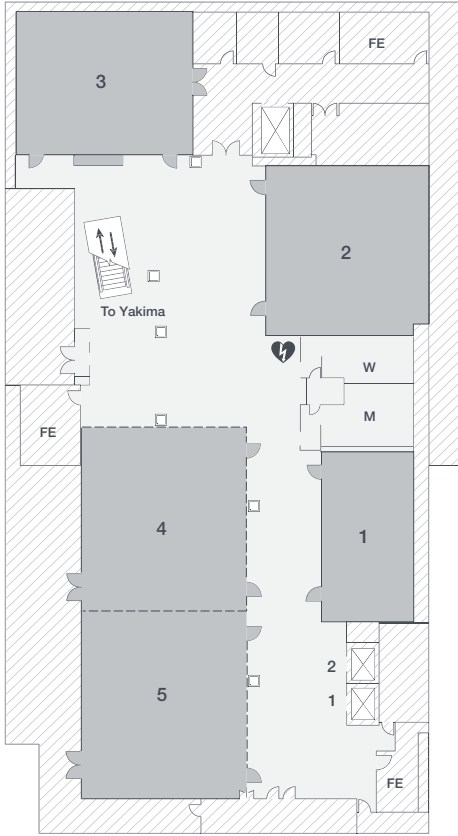

Yakima Level 1

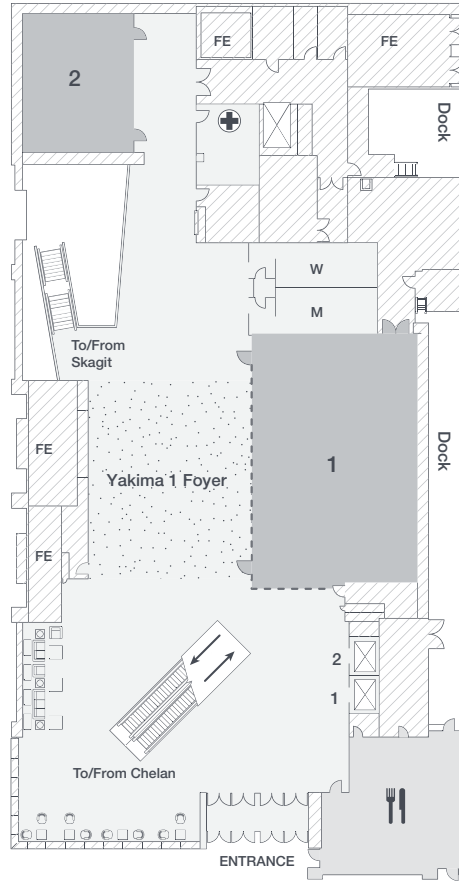

Chelan Level 2

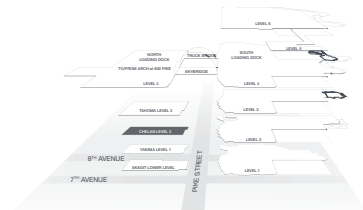
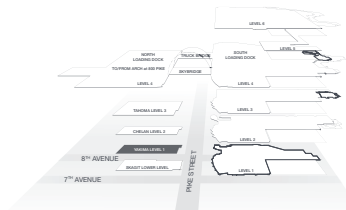
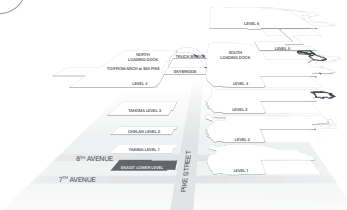
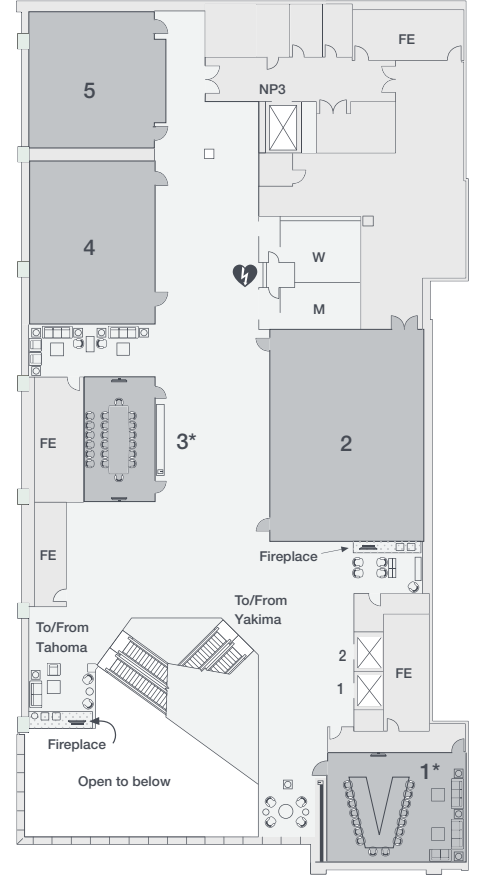

MEETING ROOMS	SQUARE FEET	DIMENSIONS	HEIGHT	THEATER	CLASSROOM 3PP	CLASSROOM 4PP	BANQUET	CONFERENCE	RECOMMENDED FRONT
Skagit 1	966	42 x 23	12	90	36	48	60	40	South
Skagit 2	1,763	43 x 41	14	171	72	96	90	56	East
Skagit 3	1,575	45 x 35	14	133	56	84	90	52	North
Skagit 4	1,927	47 x 41	14	180	72	108	120	64	West
Skagit 5	1,968	48 x 41	14	180	72	108	120	64	South
Skagit 4-5	3,936	96 x 41	14	391	160	224	240	-	South
Yakima 1	2,838	66 x 43	10' 4"	281	129	173	150	78	North
Yakima 1 + Foyer	4,875	113 x 43	10' 4"	-	-	-	-	-	-
Yakima 2	1,008	36 x 28	10' 6"	84	35	50	60	38	North
Chelan 1*	1,170	39 x 30	9'6"	-	-	-	-	16	North
Chelan 2	2,090	55 x 38	9'3"	197	90	126	120	56	North
Chelan 3*	640	32 x 20	9'6"	-	-	-	-	14	North
Chelan 4	1,344	42 x 32	9'6"	114	54	72	60	46	North
Chelan 5	1,225	35 x 35	9'6"	97	45	60	60	40	North

* Chelan 1* and 3* each feature an executive conference table and are a permanent set.

Tahoma Level 3

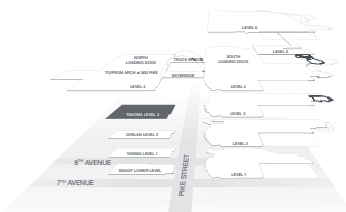
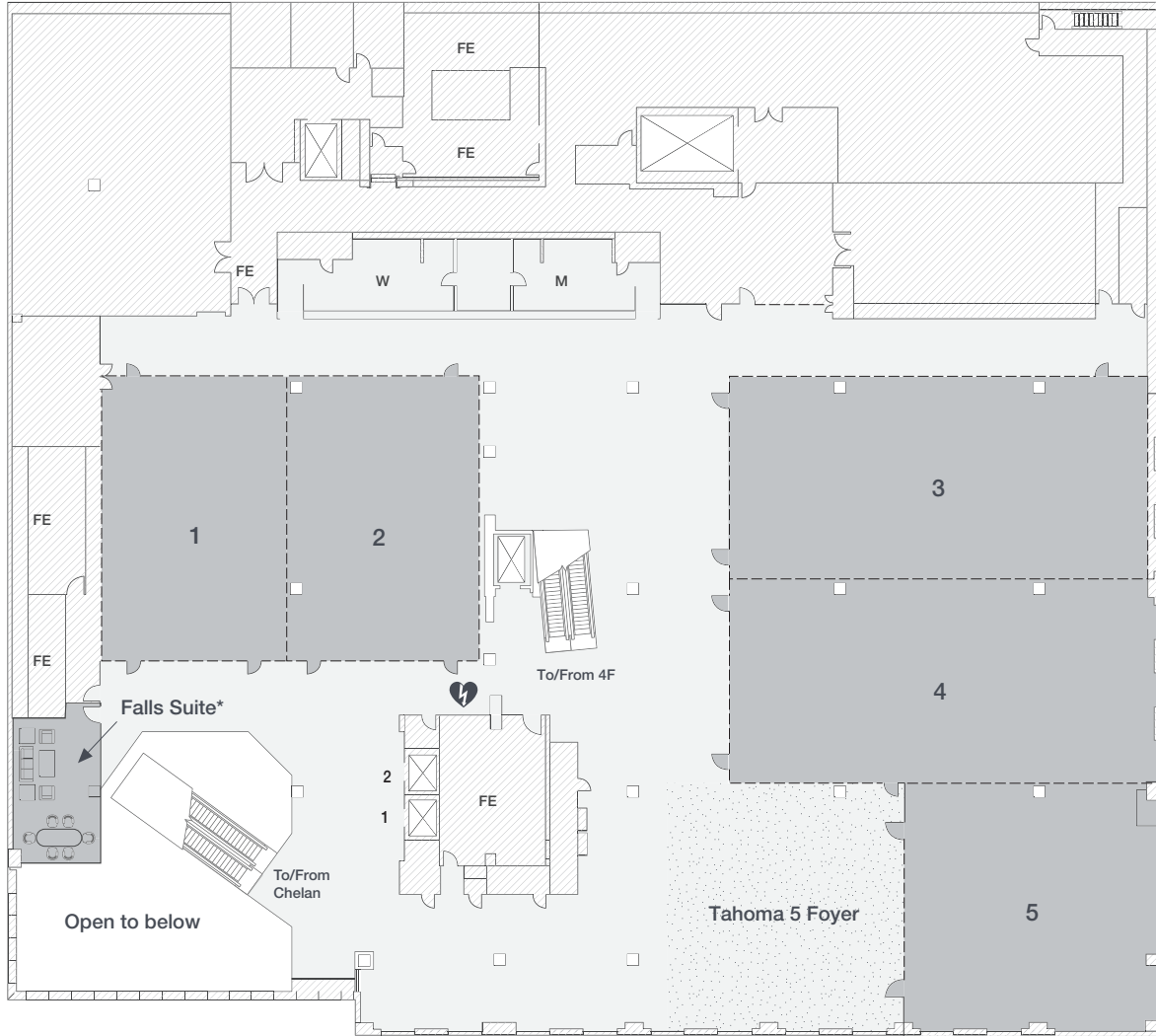

MEETING ROOMS	SQUARE FEET	DIMENSIONS	HEIGHT	THEATER	CLASSROOM		BANQUET	CONFERENCE	RECOMMENDED FRONT
					3PP	4PP			
Tahoma 1	2,542	62 x 41	15	224	100	140	150	72	North
Tahoma 2	2,604	62 x 42	15	240	112	152	150	72	North
Tahoma 1-2	5,208	62 x 84	15	485	234	312	330	-	North
Tahoma 3	4,136	94 x 44	13	408	198	266	240	104	East
Tahoma 4	4,136	94 x 44	14	408	198	266	240	104	East
Tahoma 3-4	8,366	94 x 89	13	828	396	528	520	-	North
Tahoma 5	2,856	56 x 51	15	303	126	180	160	72	East
Tahoma 5 + Foyer	5,916	116 x 51	15	-	-	-	-	-	
Falls Suite*	558	18 x 31	9	-	-	-	-	6	
Tahoma as Exhibit Space	31,000	Tahoma Level 3 can accommodate a total of (124) 10'x10' booths and (2) 8'x10' booths.							

* Permanent Set

Room Set Capacity Information

General Room Set Information

- Sample maximum set room diagrams are available upon request
- Maximum listed capacities will be reduced by optional peripheral equipment such as stages, audio visual equipment, catering services, etc.
- All exhibit, general session and registration layouts are subject to fire code review
- Stage risers are not generally set in rooms with ceiling heights less than 12' or non-combined meeting rooms

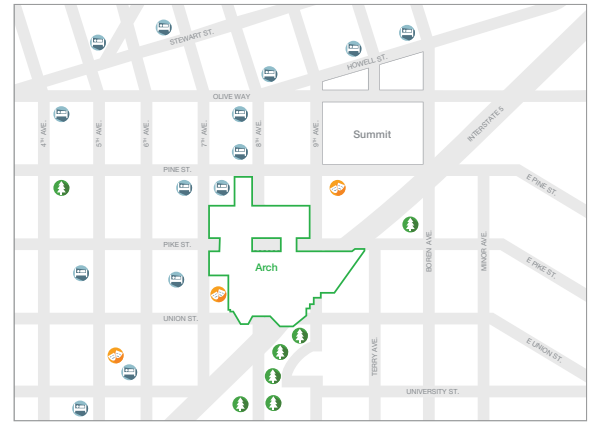

LEGEND: HOTEL PARK THEATRE

Complimentary Amenities

- Linen on classroom, conference style, and meetings set at round tables
- Table skirts on head tables and classroom aisles
- Notepads and pens provided within meeting room
- Room conversions / refreshes with sufficient notice:
 - Daytime meeting set to or from a food and beverage set
 - Overnight to or from any set or room combination
 - One daytime room refresh and nightly cleaning to GBAC STAR™ standards

<p>Chair Dimensions:</p> <ul style="list-style-type: none"> • Arch at 705 Pike chairs: 21” wide x 19” deep • Arch at 800 Pike chairs: 19½” wide x 19” deep 	<p>Theater:</p> <ul style="list-style-type: none"> • Maximum of 15 chairs per row (before aisle) • Maximum 15 rows (before aisle) • 20” space between rows (leg to leg)
<p>Classroom:</p> <ul style="list-style-type: none"> • Maximum of 3 tables per row (before aisle) • Maximum 15 rows (before aisle) • 8’ x 18’ tables as standard • 1 chair per 2’ of table • 36” space between tables 	<p>Banquet:</p> <ul style="list-style-type: none"> • 72” rounds • 10 chairs per table • 11’ centers-spacing between tables • Straight row layout as standard, staggered sets not preferred
<p>Conference:</p> <ul style="list-style-type: none"> • Conference maximum capacity may be set as board or hollow square, depending on room size • 8’x 30” tables as standard • 1 chair per 2’ of table 	<p>Riser Specifications:</p> <ul style="list-style-type: none"> • Safety rails are required on all stage risers • 6’x 8’ sections • 16”, 24”, 32”, 40” heights • Installation fee will apply for 40” units or sets exceeding 12 units • Subject to available inventory
<p>Front of Room Allowance in Capacity Counts:</p> <ul style="list-style-type: none"> • Front wall to first row for Theater and Classroom sets: <ul style="list-style-type: none"> ◦ Single meeting rooms – 10 ft ◦ Combined meeting rooms – 13 ft • No front of room allowance in Banquet or Conference sets ◦ Ballrooms 6ABCE & Hall 4C – 20 ft ◦ Exhibit Halls 4AB & 4DEF – 40 ft 	

LEGEND					
AED Device	Cash to Card Machine	Food/Beverage	Accessible Entrance Lift		
Fire Exit	Gender-Neutral Restrooms	First Aid	Seattle Visitor Center		
Event Space	Attendee Access	Retail	F & B Event Space	Back of House	Fireplace

